

It all hinges on excellence.

SIMONSWERK



Hinge Technology

Brass hinge systems

Contents

HINGE TECHONOLGY

7	TRITECH			Butt Hinge
8				Projection Hinge
9				Decorative Hinge
10				Conductor Hinge
11	COLUMBUS			
12	Hinges	Brass Hinge	Unwashed	Butt Hinge
13				Dummy Hinge
15				Butt Hinge Finial
16				Projection Hinge
17				Parliament Hinge
18				Counter Flap Hinge
20				Rising Hinge
21				Falling Hinge
22				Flush Hinge
23				Back Flap Hinge
24				Elongated Screw Hole Hinge
25			Double Phosphor Bronze	Butt Hinge
29				Projection Hinge
33			Ball Race	Butt Hinge
37				Projection Hinge
41				Paumelle Hinge
42		Stainless Steel Hinge		Rising Hinge
43				Falling Hinge
44				Spring Hinge
45		Steel Hinge		Spring Hinge
46		Aluminium Hinge	Delrin Washered	Butt Hinge
46			Double Stainless Steel	Butt Hinge
47		Nylon Hinge		Butt Hinge

HINGE TECHNOLOGY

49	Hardware	Edge Pull	Round Flat Design
50			Cube Flat Design
54		Robe Hook	
55		Magnetic Touch Latch	

TECHNICAL INFORMATION

56	Brass Hinge Finishes		
57	UK Hinge Guarantees, Hinge Types, Selection and Specification		
58	Hinges Drilled for Projection		
58	Brass Woodscrew Specification		
59	BS EN1935:2002 Standards		
61	Hinge Typical Usage / Frequency Tables		
64	Hinge Positioning		
64	Rising/Falling Hinge Handing		

SIMONSWERK UK

SIMONSWERK UK Ltd, has been producing high quality brass and aluminium hinges since 1977 and is a part of the SIMONSWERK Group. The Group is Europe's leading supplier of door and window hinge systems to the Architectural Ironmongery and Builders Hardware industry. The company is a member of the Guild of Architectural Ironmongers.

This catalogue illustrates our UK recommended selection of high performance hinges and hardware for doors, windows, cabinets and conservatories, together with a concise guide to design and use. Our experience enables us to provide in the following pages specification information to assist with the selection of that important "correct hinge for the right application". Further technical information and tables can be found at the end of this catalogue.



BRASS HINGES

The solid brass hinges are manufactured from extruded sections to precise standards and accurately machined to achieve close tolerances, fitted with different bearings for demanding applications. Due to the high copper content of brass this naturally offers anti-bacterial qualities.

Certain brass hinges within our range use a special bearing technology and are capable of carrying door weights up to 160 kilos, independently fire tested, CE and UKCA marked these hinges are suitable for use on both 30 and 60 minute fire resistant door sets.

Brass hinges can be highly decorative, we can apply a wide variety of finishes to match many different requirements, combine this with finial tips to create the perfect aesthetics for any environment.

The advantages at a glance

- with load capacities up to 160 kg
- fire tested, CE and UKCA marked options
- wide variety of finishes and finials
- anti-bacterial qualities

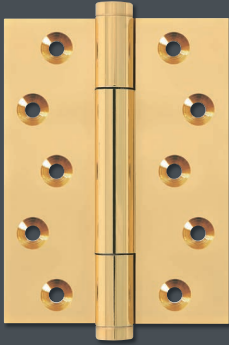

**TRITECH**

for heavy weight flush doors
 maintenance-free concealed bearings
 25 year performance guarantee
 load capacities up to 160 kg

**SAMSON**

for heavy weight flush doors
 maintenance-free concealed bearings
 25 year performance guarantee
 load capacities up to 100 kg

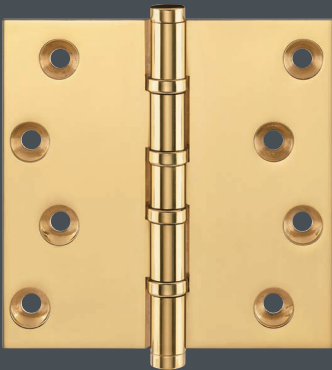
**BRASS HINGES**

unwashed brass hinges for cabinets
 and lightweight doors
 washed brass hinges for medium
 to heavy weight flush doors
 ball race for medium to heavy weight
 flush doors
 load capacities up to 80 kg

**COLUMBUS 3D**

3D adjustable
 easy door adjustment
 load capacities up to 70 kg

TRITECH

Butt hinge

Suitable for heavy weight flush doors tested to BS EN 1935 Grade 14 – 160 kg

Hinge		up to 160 kg
-------	--	--------------

Product Features

- Solid brass high performance concealed bearing hinge
- Weight carrying capacity to 160 kg
- Suitable for heavy weight flush doors tested to BS EN 1935 Grade 14
- CE and UKCA marked FD30 and FD60 fire rated options
- Maintenance free, 25 year performance guarantee
- Security bolt and radius corner options available

Technical Data	1750	1750 CE
Load capacity (3 Hinges)	160.0	160.0 kg
Overall length	100.0	100.0 mm
Overall width	76.2	76.2 mm
Knuckle diameter	13.0	13.0 mm
Material thickness	3.5	3.5 mm
Screw size (mm)	9.5x32.0	9.5x32.0 mm
Screw size (g)	10.0	10.0 g

Technical Data	1780	1780 CE
Load capacity (3 Hinges)	160.0	160.0 kg
Overall length	100.0	100.0 mm
Overall width	88.9	88.9 mm
Knuckle diameter	13.0	13.0 mm
Material thickness	3.5	3.5 mm
Screw size (mm)	9.5x32.0	9.5x32.0 mm
Screw size (g)	10.0	10.0 g

Finishes

Aged Brass (UK 501), Antique Brass (UK 502), Antique Nickel (UK 503), Copper Bronze (UK 505), Copper (UK 506), Honeycombe (UK 507), Imitation Bronze (UK 508), Midnight (UK 509), Polished Chrome (UK 511), Polished & Lacquered (UK 512), Polished Nickel (UK 513), Satin Brass & Lacquered (UK 514), Satin Chrome (UK 515), Satin Nickel (UK 516), Burnished Brass (UK 522), Polished Imitation Bronze (UK 523)

PVD Finishes: PVD Brass (UK 517), PVD Copper Rose (UK 518), PVD Matt Black (UK 519), PVD Rainbow (UK 520), PVD Stainless Steel Effect (UK 521)

Salt spray tested to over 1,000 hours

Note

Supplied complete with Pozi/Slotted Head Brass Woodscrews if required.

Classification key

4	7	7	1	1	4	0	14
---	---	---	---	---	---	---	----

BS EN1935:2002 Eight Digit Code (page 60 for details)

Finial options

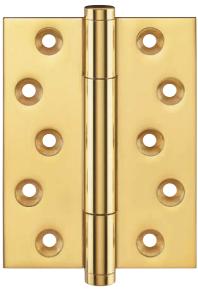

1750

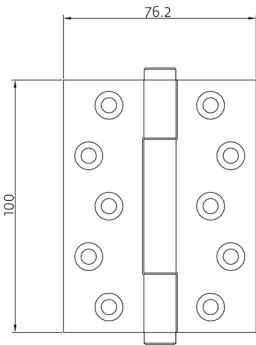

1750

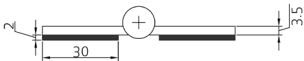
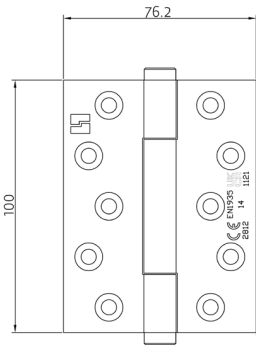

1750 CE with intumescent

TRITECH

Projection hinge

Suitable for heavy weight flush doors tested to BS EN 1935 Grade 14 – 160 kg

Hinge		up to 160 kg
-------	--	--------------

Product Features

- Solid brass high performance concealed bearing projection hinge
- Weight carrying capacity to 160 kg
- Suitable for heavy weight flush doors tested to BS EN 1935 Grade 14
- CE and UKCA marked FD30 and FD60 fire rated options
- Maintenance free, 25 year performance guarantee
- Security bolt and radius corner options available

Technical Data	P1760	P1760 CE	P1764
Load capacity (3 Hinges)	160.0	160.0	120.0 kg
Overall length	100.0	100.0	101.6 mm
Overall width	101.6	101.6	152.4 mm
Knuckle diameter	13.0	13.0	13.0 mm
Material thickness	3.5	3.5	5.0 mm
Screw size (mm)	9.5x32.0	9.5x32.0	10.9x32.0 mm
Screw size (g)	10.0	10.0	12.0 g
Amount of projection	50.0	50.0	80.0 mm

Finishes

Aged Brass (UK 501), Antique Brass (UK 502), Antique Nickel (UK 503), Copper Bronze (UK 505), Copper (UK 506), Honeycombe (UK 507), Imitation Bronze (UK 508), Midnight (UK 509), Polished Chrome (UK 511), Polished & Lacquered (UK 512), Polished Nickel (UK 513), Satin Brass & Lacquered (UK 514), Satin Chrome (UK 515), Satin Nickel (UK 516), Burnished Brass (UK 522), Polished Imitation Bronze (UK 523)

PVD Finishes: PVD Brass (UK 517), PVD Copper Rose (UK 518), PVD Matt Black (UK 519), PVD Rainbow (UK 520), PVD Stainless Steel Effect (UK 521)
Salt spray tested to over 1,000 hours

Note

Supplied complete with Pozi/Slotted Head Brass Woodscrews if required.
Find out more about projection hinges on page 58.

Classification key

4	7	7	1	1	4	0	14
---	---	---	---	---	---	---	----

BS EN1935:2002 Eight Digit Code (page 60 for details)

Finial options



P1760

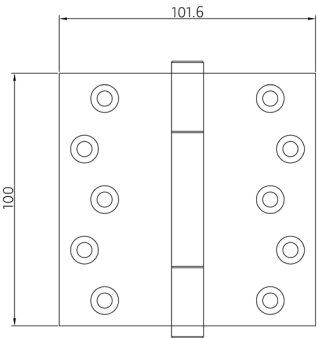

1760

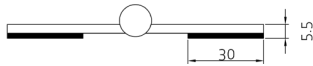

1760 CE with intumescent

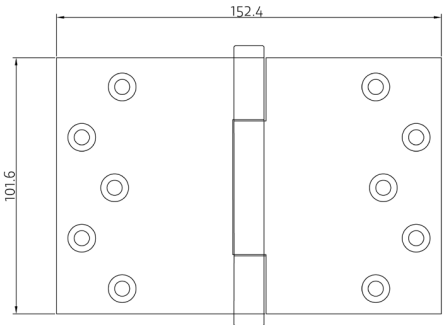

1764

TRITECH

Decorative hinge

Suitable for heavy weight flush doors tested to BS EN 1935 Grade 14 – 160 kg

Hinge		up to 160 kg
-------	--	--------------

Product Features

- Solid brass high performance concealed bearing hinge
- Weight carrying capacity to 160 kg
- Suitable for heavy weight flush doors tested to BS EN 1935 Grade 14
- Maintenance free, 25 year performance guarantee

Technical Data	1950
Load capacity (3 Hinges)	160.0 kg
Overall length	100.0 mm
Overall width	76.2 mm
Knuckle diameter	13.0 mm
Material thickness	3.5 mm
Screw size (mm)	9.5x32.0 mm
Screw size (g)	10.0 g

Technical Data	1980	1960
Load capacity (3 Hinges)	160.0	160.0 kg
Overall length	100.0	100.0 mm
Overall width	88.9	101.6 mm
Knuckle diameter	13.0	13.0 mm
Material thickness	3.5	3.5 mm
Screw size (mm)	9.5x32.0	9.5x32.0 mm
Screw size (g)	10.0	10.0 g

Finishes

Aged Brass (UK 501), Antique Brass (UK 502), Antique Nickel (UK 503), Copper Bronze (UK 505), Copper (UK 506), Honeycombe (UK 507), Imitation Bronze (UK 508), Midnight (UK 509), Polished Chrome (UK 511), Polished & Lacquered (UK 512), Polished Nickel (UK 513), Satin Brass & Lacquered (UK 514), Satin Chrome (UK 515), Satin Nickel (UK 516), Burnished Brass (UK 522), Polished Imitation Bronze (UK 523)

PVD Finishes: PVD Brass (UK 517), PVD Copper Rose (UK 518), PVD Matt Black (UK 519), PVD Rainbow (UK 520), PVD Stainless Steel Effect (UK 521)

Salt spray tested to over 1,000 hours

Note

Supplied complete with Pozi/Slotted Head Brass Woodscrews if required.

Finial options

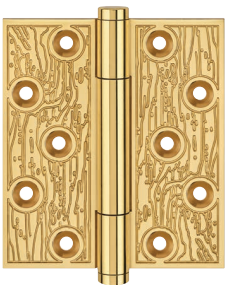

Flowing Bark

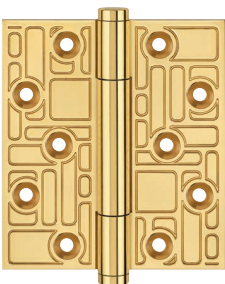

Recurring Rectangles

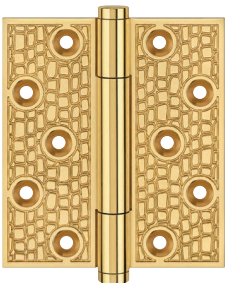

Gator Reflections

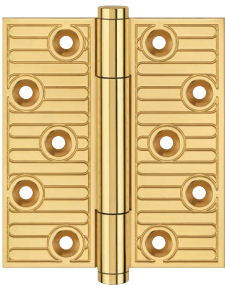

Skateline

Note: Please see website for more designs.



TRITECH

Conductor hinge

Suitable for medium to heavy weight flush doors

Conductor hinge		
Product Features		
<ul style="list-style-type: none">• Solid brass conductor hinge• Suitable for medium to heavy weight flush doors when combined with Ref. 1750• Hidden transfer of wires from door to frame eliminates the need for an armoured loop• Capacity 2 wire 24V 5 Amps• 2 or 4 wire options• Radius corner options available		

Technical Data	1750 C4
Overall length	100.0 mm
Overall width	76.2 mm
Knuckle diameter	13.0 mm
Material thickness	3.5 mm
Screw size (mm)	9.5x32.0 mm
Screw size (g)	10.0 g

Combinations	
Hinge	Ref. 1750

Finishes
Aged Brass (UK 501), Antique Brass (UK 502), Antique Nickel (UK 503), Copper Bronze (UK 505), Copper (UK 506), Honeycombe (UK 507), Imitation Bronze (UK 508), Midnight (UK 509), Polished Chrome (UK 511), Polished & Lacquered (UK 512), Polished Nickel (UK 513), Satin Brass & Lacquered (UK 514), Satin Chrome (UK 515), Satin Nickel (UK 516), Burnished Brass (UK 522), Polished Imitation Bronze (UK 523)

Note
Supplied complete with Pozi/Slotted Head Brass Woodscrews if required.
Other sizes available on request.

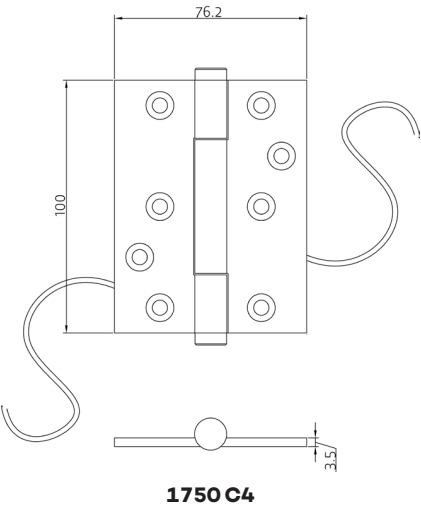
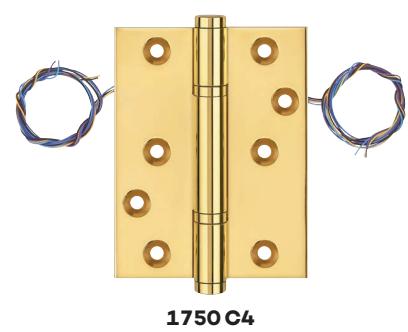

COLUMBUS

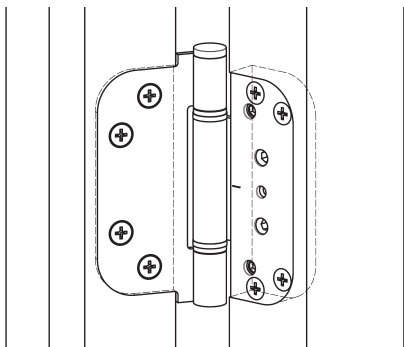

Columbus 3D

Easy adjustment to door position in all three directions

Hinge	3D adjustable	up to 70 kg
-------	---------------	-------------

Product Features

- Quick and easy mounting
- Maintenance free
- (MSTS) Security device for outward opening doors
- Three way adjustable hinges allow adjustment to doors horizontally, vertically and compression by turning socket screws

Technical Data

Load capacity (3 Hinges)	70.0 kg
Overall length	101.6 mm
Overall width	88.0 mm
Knuckle diameter	13.0 mm
Material thickness	2.5 mm
Receiver depth	14.0 mm

Adjustment

Overall length	+/- 3mm
Side	+/- 2mm
Depth	+/- 4mm

Finishes

include: Brassed, Satin Stainless Steel, Polished Stainless Steel
Powder Coated Colours: Silver, White, Black, Brown, Gold
Other finishes available to special order

Note

Fixing screws are not supplied.

Brass Hinge

Unwashed

Suitable for cabinets and lightweight flush doors and windows

Butt hinge		
------------	--	--

Product Features

- Brass pin
- 10 year performance guarantee
- Suitable for lightweight flush doors and windows

Technical Data	0920	0940	0950
Load capacity (3 Hinges)	–	–	– kg
Overall length	38.0	50.8	50.8 mm
Overall width	22.2	28.8	38.1 mm
Knuckle diameter	4.0	5.0	6.3 mm
Material thickness	1.6	1.7	2.3 mm
Screw size (mm)	5.3x12.7	5.3x12.7	6.7x19.0 mm
Screw size (g)	4.0	4.0	6.0 g

Technical Data	0960	0962
Load capacity (3 Hinges)	–	– kg
Overall length	63.5	63.5 mm
Overall width	35.3	38.1 mm
Knuckle diameter	5.5	6.3 mm
Material thickness	2.0	2.3 mm
Screw size (mm)	6.7x19.0	8.1x25.4 mm
Screw size (g)	6.0	8.0 g

Technical Data	0965	0970
Load capacity (3 Hinges)	10.0	10.0 kg
Overall length	75.0	75.0 mm
Overall width	35.3	41.9 mm
Knuckle diameter	5.5	6.0 mm
Material thickness	2.0	2.0 mm
Screw size (mm)	6.7x19.0	8.1x25.4 mm
Screw size (g)	6.0	8.0 g

Technical Data	1010	1020	1030
Load capacity (3 Hinges)	20.0	20.0	20.0 kg
Overall length	75.0	76.2	100.0 mm
Overall width	51.2	60.9	60.9 mm
Knuckle diameter	7.8	8.5	8.5 mm
Material thickness	2.9	3.0/3.6	3.1 mm
Screw size (mm)	8.1x25.4	8.1x25.4	9.5x32.0 mm
Screw size (g)	8.0	8.0	10.0 g

Technical Data	1040	1050	1070
Load capacity (3 Hinges)	20.0	20.0	20.0 kg
Overall length	100.0	100.0	127.0 mm
Overall width	65.0	75.0	75.0 mm
Knuckle diameter	9.2	11.0	11.0 mm
Material thickness	3.5	4.0	4.0 mm
Screw size (mm)	9.5x32.0	9.5x32.0	10.9x32.0 mm
Screw size (g)	10.0	10.0	12.0 g

Finishes

Aged Brass (UK 501), Antique Brass (UK 502), Antique Nickel (UK 503), Copper Bronze (UK 505), Copper (UK 506), Honeycombe (UK 507), Imitation Bronze (UK 508), Midnight (UK 509), Polished Chrome (UK 511), Polished & Lacquered (UK 512), Polished Nickel (UK 513), Satin Brass & Lacquered (UK 514), Satin Chrome (UK 515), Satin Nickel (UK 516), Burnished Brass (UK 522), Polished Imitation Bronze (UK 523)

Note

Supplied complete with Pozi/Slotted Head Brass Woodscrews if required.



0960

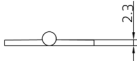
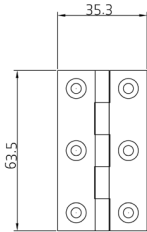

0960

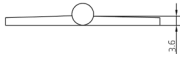
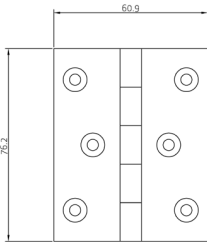

1020

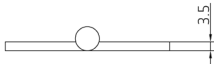
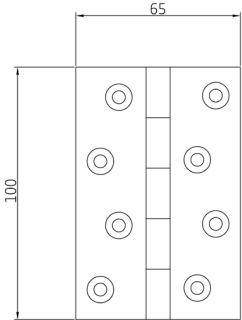

1040



0690

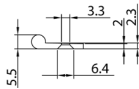
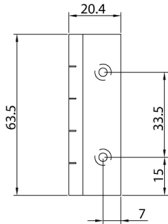

0790

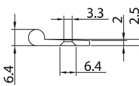
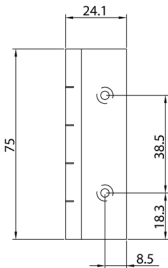

Brass Hinge

Unwashed

Suitable for use of cabinets and lightweight doors

Dummy hinge		
-------------	--	--

Product Features

- For use with ref. 0960 brass hinge
- Replicates the appearance of a butt hinge
- For decorative purposes

Technical Data	0690
Knuckle diameter	5.5 mm
Overall length	63.5 mm
Overall width	20.4 mm
Material thickness	2.0 mm
Screw size (mm)	5.3x12.7 mm
Screw size (g)	4.0 g

Combinations

Hinge	Ref. 0960
-------	-----------

Finishes

Aged Brass (UK 501), Antique Brass (UK 502), Antique Nickel (UK 503), Copper Bronze (UK 505), Copper (UK 506), Honeycombe (UK 507), Imitation Bronze (UK 508), Midnight (UK 509), Polished Chrome (UK 511), Polished & Lacquered (UK 512), Polished Nickel (UK 513), Satin Brass & Lacquered (UK 514), Satin Chrome (UK 515), Satin Nickel (UK 516), Burnished Brass (UK 522), Polished Imitation Bronze (UK 523)

Unwashed

Suitable for use of cabinets and lightweight doors

Dummy hinge		
-------------	--	--

Product Features

- for use with ref. 0970 brass hinges
- replicates the appearance of a butt hinge
- for decorative purposes

Technical Data	0790
Knuckle diameter	6.0 mm
Overall length	75.0 mm
Overall width	24.1 mm
Material thickness	2.0 mm
Screw size (mm)	5.3x12.7 mm
Screw size (g)	4.0 g

Combinations

Hinge	Ref. 0970
-------	-----------

Finishes

Aged Brass (UK 501), Antique Brass (UK 502), Antique Nickel (UK 503), Copper Bronze (UK 505), Copper (UK 506), Honeycombe (UK 507), Imitation Bronze (UK 508), Midnight (UK 509), Polished Chrome (UK 511), Polished & Lacquered (UK 512), Polished Nickel (UK 513), Satin Brass & Lacquered (UK 514), Satin Chrome (UK 515), Satin Nickel (UK 516), Burnished Brass (UK 522), Polished Imitation Bronze (UK 523)

Brass Hinge

Unwashed

Suitable for use of cabinets and lightweight doors

Dummy hinge

Product Features

- For use with ref. 0970 brass hinges
- Replicates the appearance of a butt hinge
- For decorative purposes

Technical Data	0791
Knuckle diameter	6.35 mm
Overall length	75.0 mm
Overall width	9.5 mm

Combinations

Brass hinge	Ref. 0970
-------------	-----------

Finishes

Aged Brass (UK 501), Antique Brass (UK 502), Antique Nickel (UK 503), Copper Bronze (UK 505), Copper (UK 506), Honeycombe (UK 507), Imitation Bronze (UK 508), Midnight (UK 509), Polished Chrome (UK 511), Polished & Lacquered (UK 512), Polished Nickel (UK 513), Satin Brass & Lacquered (UK 514), Satin Chrome (UK 515), Satin Nickel (UK 516), Burnished Brass (UK 522), Polished Imitation Bronze (UK 523)

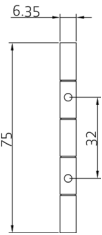

Brass Hinge

Unwashed

Suitable for cabinets and lightweight flush doors and windows

Butt hinge		Finial
------------	--	--------

Product Features

- Optional detachable decorative finials
- Stainless steel pin
- 10 year performance guarantee
- Suitable for cabinets and lightweight flush doors and windows



0325

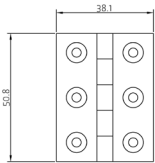

0305

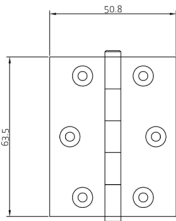
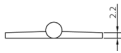

0315

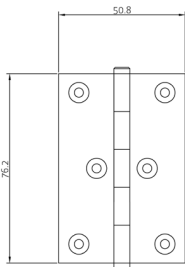
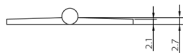

0325

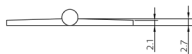

Technical Data	0305
Load capacity (3 Hinges)	20.0 kg
Overall length	50.8 mm
Overall width	38.1 mm
Knuckle diameter	6.3 mm
Material thickness	2.2 mm
Screw size (mm)	6.7x19.0 mm
Screw size (g)	6.0 g

Technical Data	0315	0325
Load capacity (3 Hinges)	20.0	20.0 kg
Overall length	63.5	76.2 mm
Overall width	50.8	50.8 mm
Knuckle diameter	6.3	6.3 mm
Material thickness	2.2	2.2 mm
Screw size (mm)	6.7x19.0	6.7x19.0 mm
Screw size (g)	6.0	6.0 g

Finishes

Aged Brass (UK 501), Antique Brass (UK 502), Antique Nickel (UK 503), Copper Bronze (UK 505), Copper (UK 506), Honeycombe (UK 507), Imitation Bronze (UK 508), Midnight (UK 509), Polished Chrome (UK 511), Polished & Lacquered (UK 512), Polished Nickel (UK 513), Satin Brass & Lacquered (UK 514), Satin Chrome (UK 515), Satin Nickel (UK 516), Burnished Brass (UK 522), Polished Imitation Bronze (UK 523)

Note

Supplied complete with fixing screws if required.

Finial options



Steeple



Ball



Button tip



Urn



Brass Hinge

Unwashed

Suitable for lightweight flush doors and windows

Projection hinge		
------------------	--	--

Product Features

- Solid brass plain unwashed projection hinge
- Brass pin
- 10 year performance guarantee
- Suitable for lightweight flush doors and windows

Technical Data	P1025	P1060
Load capacity (3 Hinges)	20.0	20.0 kg
Overall length	76.2	100.0 mm
Overall width	75.0	103.2 mm
Knuckle diameter	11.0	11.0 mm
Material thickness	4.0	4.0 mm
Screw size (mm)	9.5x32.0	10.9x32.0 mm
Screw size (g)	10.0	12.0 g
Amount of projection	32.0	50.0 mm

Finishes

Aged Brass (UK 501), Antique Brass (UK 502), Antique Nickel (UK 503), Copper Bronze (UK 505), Copper (UK 506), Honeycombe (UK 507), Imitation Bronze (UK 508), Midnight (UK 509), Polished Chrome (UK 511), Polished & Lacquered (UK 512), Polished Nickel (UK 513), Satin Brass & Lacquered (UK 514), Satin Chrome (UK 515), Satin Nickel (UK 516), Burnished Brass (UK 522), Polished Imitation Bronze (UK 523)

Note

Supplied complete with Pozi/Slotted Head Brass Woodscrews if required.
Find out more about projection hinges on page 59.



P1060

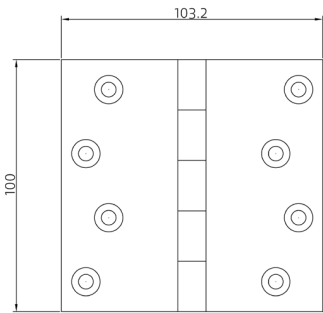

P1060



Brass Hinge

Unwashed

Suitable for lightweight flush doors and French windows

Parliament hinge

Product Features

- Brass pin
- 10 year performance guarantee
- Suitable for lightweight flush doors and French windows

Technical Data	P0550	P0560	P0570
Load capacity (3 Hinges)	25.0	30.0	35.0 kg
Overall length	101.6	101.6	101.6 mm
Overall width	103.2	127.0	152.4 mm
Knuckle diameter	11.0	12.7	12.7 mm
Material thickness	4.0	5.0	5.0 mm
Screw size (mm)	9.5x32.0	9.5x32.0	10.9x32.0 mm
Screw size (g)	10.0	10.0	12.0 g
Amount of projection	64.0	75.0	100.0 mm

Finishes

Aged Brass (UK 501), Antique Brass (UK 502), Antique Nickel (UK 503), Copper Bronze (UK 505), Copper (UK 506), Honeycombe (UK 507), Imitation Bronze (UK 508), Midnight (UK 509), Polished Chrome (UK 511), Polished & Lacquered (UK 512), Polished Nickel (UK 513), Satin Brass & Lacquered (UK 514), Satin Chrome (UK 515), Satin Nickel (UK 516), Burnished Brass (UK 522), Polished Imitation Bronze (UK 523)

Note

Supplied complete with Pozi/Slotted Head Brass Woodscrews if required.

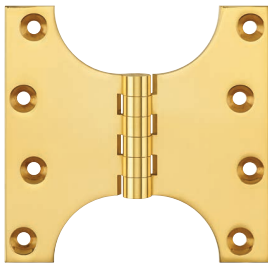

P0550

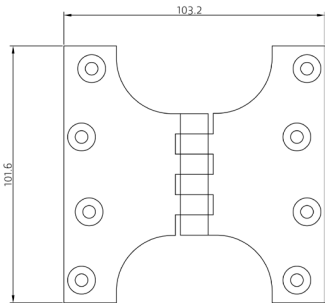

P0550

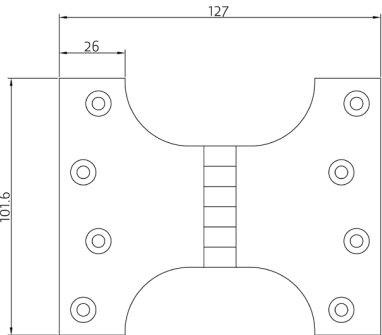

P0560

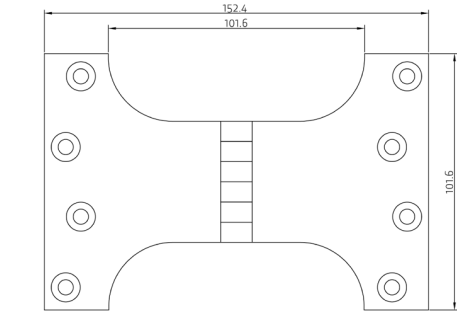

P0570



Brass Hinge

Unwashed

Suitable for bar and shop counters

Counter flap		Dovetail hinge
--------------	--	----------------

Product Features

- Suitable for flush wooden counters

Technical Data	0510	0520
Load capacity (2 Hinges)	10.0	10.0 kg
Overall length	31.0/38.0	38.0/44.5 mm
Overall width	102.6	115.0 mm
Material thickness	3.0	4.0 mm
Screw size (mm)	9.5x32.0	9.5x32.0 mm
Screw size (g)	10.0	10.0 g

Finishes

Aged Brass (UK 501), Antique Brass (UK 502), Antique Nickel (UK 503), Copper Bronze (UK 505), Copper (UK 506), Honeycombe (UK 507), Imitation Bronze (UK 508), Midnight (UK 509), Polished Chrome (UK 511), Polished & Lacquered (UK 512), Polished Nickel (UK 513), Satin Brass & Lacquered (UK 514), Satin Chrome (UK 515), Satin Nickel (UK 516), Burnished Brass (UK 522), Polished Imitation Bronze (UK 523)

Note

Supplied complete with Pozi/Slotted Head Brass Woodscrews if required.



0510

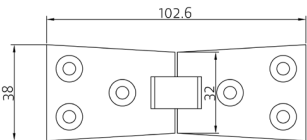

0510

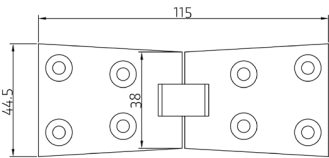

0520

Unwashed

Suitable for bar and shop counters

Counter flap		Radius hinge
--------------	--	--------------

Product Features

- Suitable for flush wooden counters
- Radius Ends for easy mortice

Technical Data	0610
Overall length	34.5 mm
Overall width	75.0 mm
Material thickness	4.0 mm
Screw size (mm)	9.5x32.0 mm
Screw size (g)	10.0 g

Finishes

Aged Brass (UK 501), Antique Brass (UK 502), Antique Nickel (UK 503), Copper Bronze (UK 505), Copper (UK 506), Honeycombe (UK 507), Imitation Bronze (UK 508), Midnight (UK 509), Polished Chrome (UK 511), Polished & Lacquered (UK 512), Polished Nickel (UK 513), Satin Brass & Lacquered (UK 514), Satin Chrome (UK 515), Satin Nickel (UK 516), Burnished Brass (UK 522), Polished Imitation Bronze (UK 523)

Note

Supplied complete with Pozi/Slotted Head Brass Woodscrews if required.



0610

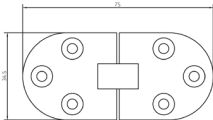

0610

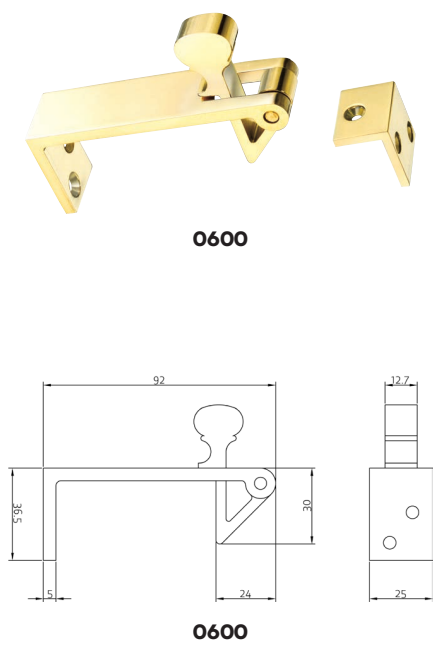

Brass Hinge

Counter Flap Catch

Suitable for bar and shop counters

Counter flap	Catch
--------------	-------

Product Features

- Suitable for bar and shop counters
- Catch holds counter at 90 degrees until released

Technical Data	O600
Overall length	36.5 mm
Overall width	92.0 mm
Max Counter Thickness	53.0 mm
Material thickness	4.0 mm
Screw size (mm)	6.7x19.0 mm
Screw size (g)	6.0 g

Finishes

Aged Brass (UK 501), Antique Brass (UK 502), Antique Nickel (UK 503), Copper Bronze (UK 505), Copper (UK 506), Honeycombe (UK 507), Imitation Bronze (UK 508), Midnight (UK 509), Polished Chrome (UK 511), Polished & Lacquered (UK 512), Polished Nickel (UK 513), Satin Brass & Lacquered (UK 514), Satin Chrome (UK 515), Satin Nickel (UK 516), Burnished Brass (UK 522), Polished Imitation Bronze (UK 523)

Note

Supplied complete with Pozi/Slotted Head Brass Woodscrews if required.

Brass Hinge

Unwashed

Suitable for medium weight toilet cubicle and internal flush doors

Rising hinge	
Product Features	
• Rise or fall of 13 mm at 180°	
• Brass pin	
• Suitable for medium weight toilet cubicle and internal flush doors	
• Fitted with heavy duty bronze skewers for long life and high resistance to corrosion	
• Radius corners optional, by special request	
• Handed left or right - see figure 2 on page 65	

Technical Data	1840
Load capacity (2 Hinges)	45.0 kg
Overall length	100.0 mm
Overall width	66.7 mm
Knuckle diameter	14.5 mm
Material thickness	4.0 mm
Screw size (mm)	9.5x32.0 mm
Screw size (g)	10.0 g

Finishes
Aged Brass (UK 501), Antique Brass (UK 502), Antique Nickel (UK 503), Copper Bronze (UK 505), Copper (UK 506), Honeycombe (UK 507), Imitation Bronze (UK 508), Midnight (UK 509), Polished Chrome (UK 511), Polished & Lacquered (UK 512), Polished Nickel (UK 513), Satin Brass & Lacquered (UK 514), Satin Chrome (UK 515), Satin Nickel (UK 516), Burnished Brass (UK 522), Polished Imitation Bronze (UK 523)

Note
Supplied complete with Pozi/Slotted Head Brass Woodscrews if required.



1840

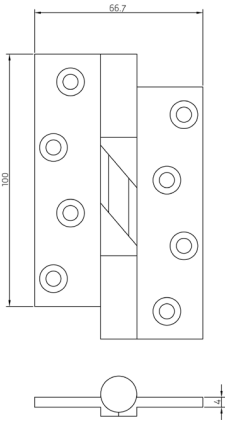

1840



1841

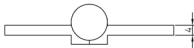
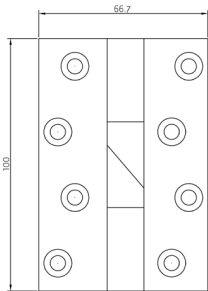

1841

Brass Hinge

Unwashed

Suitable for medium weight toilet cubicle and internal flush doors

Falling hinge

Product Features

- Rise or fall of 13 mm at 180°
- Brass pin
- Suitable for medium weight toilet cubicle and internal flush doors
- Fitted with heavy duty bronze skews for long life and high resistance to corrosion
- Radius corners optional, by special request
- Handed left or right - see figure 2 on page 65

Technical Data

1841

Load capacity (2 Hinges)	45.0 kg
Overall length	100.0 mm
Overall width	66.7 mm
Knuckle diameter	14.5 mm
Material thickness	4.0 mm
Screw size (mm)	9.5x32.0 mm
Screw size (g)	10.0 g

Finishes

Aged Brass (UK 501), Antique Brass (UK 502), Antique Nickel (UK 503), Copper Bronze (UK 505), Copper (UK 506), Honeycombe (UK 507), Imitation Bronze (UK 508), Midnight (UK 509), Polished Chrome (UK 511), Polished & Lacquered (UK 512), Polished Nickel (UK 513), Satin Brass & Lacquered (UK 514), Satin Chrome (UK 515), Satin Nickel (UK 516), Burnished Brass (UK 522), Polished Imitation Bronze (UK 523)

Note

Supplied complete with Pozi/Slotted Head Brass Woodscrews if required.

Brass Hinge

Unwashed

Suitable for use on cabinets and lightweight doors

Flush hinge		
-------------	--	--

Product Features

- Brass pin
- Brass flush hinges reducing the need to mortice hinges into cabinets
- Suitable for use on cabinets and lightweight doors

Technical Data	0985	0990
Load capacity (2 Hinges)	5.0	7.5 kg
Overall length	50.8	63.5 mm
Overall width	21.5	21.5 mm
Knuckle diameter	5.0	5.0 mm
Material thickness	1.7	1.7 mm
Screw size (mm)	5.3x12.7	5.3x12.7 mm
Screw size (g)	4.0	4.0 g

Finishes

Aged Brass (UK 501), Antique Brass (UK 502), Antique Nickel (UK 503), Copper Bronze (UK 505), Copper (UK 506), Honeycombe (UK 507), Imitation Bronze (UK 508), Midnight (UK 509), Polished Chrome (UK 511), Polished & Lacquered (UK 512), Polished Nickel (UK 513), Satin Brass & Lacquered (UK 514), Satin Chrome (UK 515), Satin Nickel (UK 516), Burnished Brass (UK 522), Polished Imitation Bronze (UK 523)

Note

Supplied complete with Pozi/Slotted Head Brass Woodscrews if required.



0985

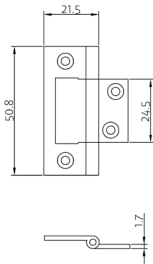

0985

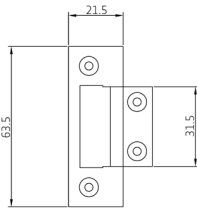

0990

Brass Hinge

Unwashed

Suitable for use on wooden box lids, wooden chests etc.

Back flap hinge

Product Features

- Brass pin
- 10 year performance guarantee
- Suitable for use on wooden box lids, wooden chests etc



0425

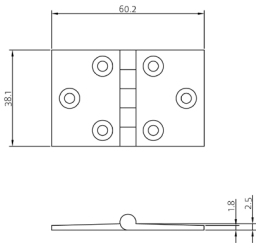

0410

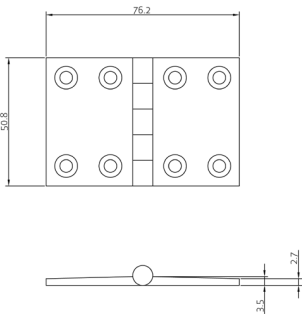

0420

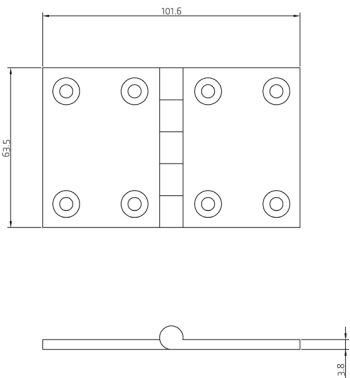

0425

Technical Data	0400	0410
Load capacity (3 Hinges)	5.0	10.0 kg
Overall length	32.0	38.1 mm
Overall width	47.5	60.2 mm
Knuckle diameter	5.5	6.3 mm
Material thickness	1.9	1.8/2.5 mm
Screw size (mm)	6.7x19.0	6.7x19.0 mm
Screw size (g)	6.0	6.0 g

Technical Data	0420	0425
Load capacity (3 Hinges)	15.0	15.0 kg
Overall length	50.8	63.5 mm
Overall width	76.2	101.6 mm
Knuckle diameter	7.8	9.3 mm
Material thickness	3.5/2.7	3.8 mm
Screw size (mm)	8.1x25.4	9.5x32.0 mm
Screw size (g)	8.0	10.0 g

Finishes

Aged Brass (UK 501), Antique Brass (UK 502), Antique Nickel (UK 503), Copper Bronze (UK 505), Copper (UK 506), Honeycombe (UK 507), Imitation Bronze (UK 508), Midnight (UK 509), Polished Chrome (UK 511), Polished & Lacquered (UK 512), Polished Nickel (UK 513), Satin Brass & Lacquered (UK 514), Satin Chrome (UK 515), Satin Nickel (UK 516), Burnished Brass (UK 522), Polished Imitation Bronze (UK 523)

Note

Supplied complete with Pozi/Slotted Head Brass Woodscrews if required.



Brass Hinge

Unwashed

Suitable for use on cabinets and lightweight doors

Elongated screw hole hinge		
----------------------------	--	--

Product Features

- Brass elongated screw hole cabinet hinges allowing fine adjustment before final fit
- Brass pin
- 10 year performance guarantee
- Suitable for use on cabinets and lightweight doors

Technical Data	0950 EH	0960 EH	0970 EH
Load capacity (3 Hinges)	10.0	10.0	10.0 kg
Overall length	50.8	63.5	75.0 mm
Overall width	38.1	35.3	41.9 mm
Knuckle diameter	6.0	5.5	6.0 mm
Material thickness	2.3	2.0	2.0 mm
Screw size (mm)	6.7x19.0	6.7x19.0	8.1x25.4 mm
Screw size (g)	6.0	6.0	8.0 g

Finishes

Aged Brass (UK 501), Antique Brass (UK 502), Antique Nickel (UK 503), Copper Bronze (UK 505), Copper (UK 506), Honeycombe (UK 507), Imitation Bronze (UK 508), Midnight (UK 509), Polished Chrome (UK 511), Polished & Lacquered (UK 512), Polished Nickel (UK 513), Satin Brass & Lacquered (UK 514), Satin Chrome (UK 515), Satin Nickel (UK 516), Burnished Brass (UK 522), Polished Imitation Bronze (UK 523)

Note

Supplied complete with Pozi/Slotted Head Brass Woodscrews if required.
Available with one or two slots. Two slots are standard.



0970 EH

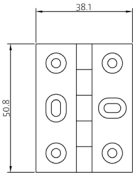

0950 EH

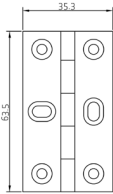

0960 EH

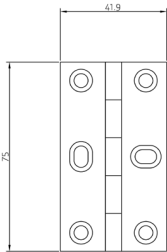

0970 EH



Brass Hinge

Washed Double Phosphor Bronze

Suitable for medium weight flush doors

Butt hinge

Product Features

- Double phosphor bronze tab washed brass butt hinges
- Knurled brass plugs for flush end appearance
- Brass pin
- 10 year performance guarantee
- Suitable for medium weight flush doors
- Security bolt and radius corner options available

Technical Data

	1210	1240
Load capacity (3 Hinges)	20.0	40.0 kg
Overall length	75.0	100.0 mm
Overall width	51.2	65.0 mm
Knuckle diameter	7.8	9.2 mm
Material thickness	3.0	3.5 mm
Screw size (mm)	8.1x25.4	9.5x32.0 mm
Screw size (g)	8.0	10.0 g

Technical Data

	1250	1270	1280
Load capacity (3 Hinges)	40.0	40.0	40.0 kg
Overall length	100.0	127.0	152.4 mm
Overall width	75.0	75.0	75.0 mm
Knuckle diameter	11.0	11.0	11.0 mm
Material thickness	4.0	4.0	4.0 mm
Screw size (mm)	9.5x32.0	10.9x32.0	10.9x32.0 mm
Screw size (g)	10.0	12.0	12.0 g

Finishes

Aged Brass (UK 501), Antique Brass (UK 502), Antique Nickel (UK 503), Copper Bronze (UK 505), Copper (UK 506), Honeycombe (UK 507), Imitation Bronze (UK 508), Midnight (UK 509), Polished Chrome (UK 511), Polished & Lacquered (UK 512), Polished Nickel (UK 513), Satin Brass & Lacquered (UK 514), Satin Chrome (UK 515), Satin Nickel (UK 516), Burnished Brass (UK 522), Polished Imitation Bronze (UK 523)

Note

Supplied complete with Pozi/Slotted Head Brass Woodscrews if required.

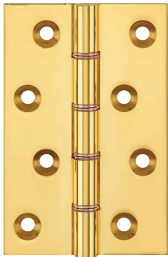

1240

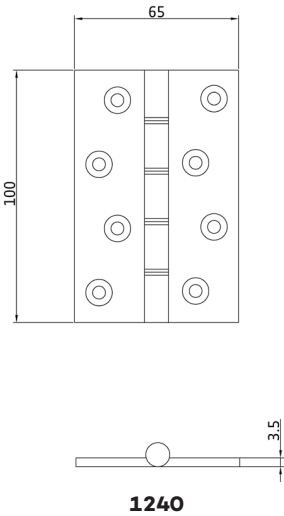

1240

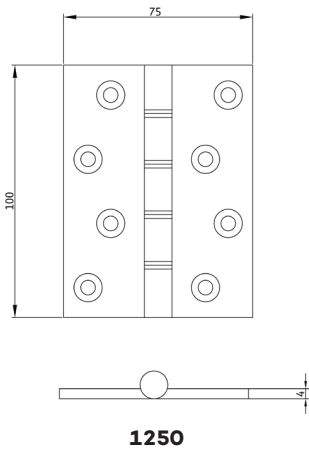

1250



Brass Hinge

Washed Double Phosphor Bronze

Suitable for medium weight flush doors

Butt hinge		Finial
------------	--	--------

Product Features

- Double phosphor bronze tab washed brass butt hinges
- Brass pin
- 10 year performance guarantee
- Suitable for medium weight flush doors
- Security bolt and radius corner options available

Technical Data	1410	1440
Load capacity (3 Hinges)	20.0	40.0 kg
Overall length	75.0	100.0 mm
Overall width	51.2	65.0 mm
Knuckle diameter	7.8	9.2 mm
Material thickness	3.0	3.5 mm
Screw size (mm)	8.1x25.4	9.5x32.0 mm
Screw size (g)	8.0	10.0 g

Technical Data	1450	1470	1480
Load capacity (3 Hinges)	40.0	40.0	40.0 kg
Overall length	100.0	127.0	152.4 mm
Overall width	75.0	75.0	75.0 mm
Knuckle diameter	11.0	11.0	11.0 mm
Material thickness	4.0	4.0	4.0 mm
Screw size (mm)	9.5x32.0	10.9x32.0	10.9x32.0 mm
Screw size (g)	10.0	12.0	12.0 g

Finishes

Aged Brass (UK 501), Antique Brass (UK 502), Antique Nickel (UK 503), Copper Bronze (UK 505), Copper (UK 506), Honeycombe (UK 507), Imitation Bronze (UK 508), Midnight (UK 509), Polished Chrome (UK 511), Polished & Lacquered (UK 512), Polished Nickel (UK 513), Satin Brass & Lacquered (UK 514), Satin Chrome (UK 515), Satin Nickel (UK 516), Burnished Brass (UK 522), Polished Imitation Bronze (UK 523)

Note

Supplied complete with Pozi/Slotted Head Brass Woodscrews if required.

Finial options

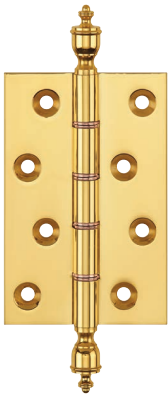

1440

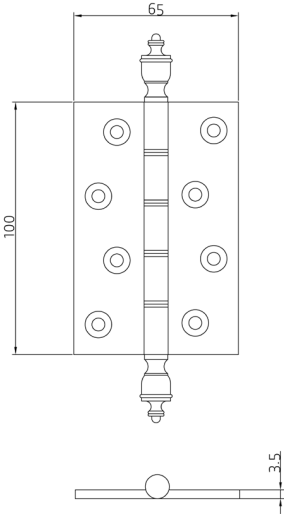

1440

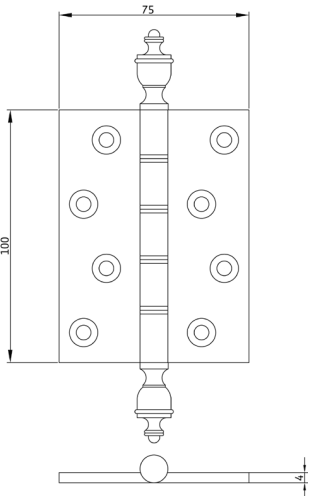

1450



Brass Hinge

Washed Double Phosphor Bronze

Suitable for medium weight flush doors

Butt hinge	CE certified
------------	--------------

Product Features

- Double phosphor bronze tab washed brass butt hinges
- Knurled brass plugs for flush end appearance
- CE and UKCA marked FD30 fire rated
- Brass pin
- 10 year performance guarantee
- Suitable for medium weight flush doors
- Security bolt and radius corner options available

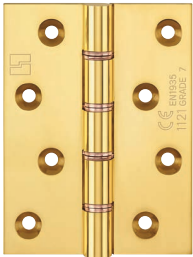

1250 CE

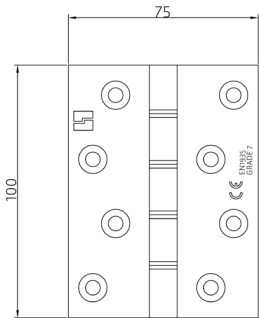

1250 CE with intumescent

Technical Data	1240 CE	1250 CE
Load capacity (3 Hinges)	40.0	40.0 kg
Overall length	100.0	100.0 mm
Overall width	65.0	75.0 mm
Knuckle diameter	9.2	11.0 mm
Material thickness	3.5	4.0 mm
Screw size (mm)	9.5x32.0	9.5x32.0 mm
Screw size (g)	10.0	10.0 g

Technical Data	1270 CE	1280 CE
Load capacity (3 Hinges)	40.0	40.0 kg
Overall length	127.0	152.4 mm
Overall width	75.0	75.0 mm
Knuckle diameter	11.0	11.0 mm
Material thickness	4.0	4.0 mm
Screw size (mm)	10.9x32.0	10.9x32.0 mm
Screw size (g)	12.0	12.0 g

Finishes

Aged Brass (UK 501), Antique Brass (UK 502), Antique Nickel (UK 503), Copper Bronze (UK 505), Copper (UK 506), Honeycombe (UK 507), Imitation Bronze (UK 508), Midnight (UK 509), Polished Chrome (UK 511), Polished & Lacquered (UK 512), Polished Nickel (UK 513), Satin Brass & Lacquered (UK 514), Satin Chrome (UK 515), Satin Nickel (UK 516), Burnished Brass (UK 522), Polished Imitation Bronze (UK 523)

Note

Supplied complete with Pozi/Slotted Head Brass Woodscrews if required.

Classification key

2	7	2	1	1	4	0	7
---	---	---	---	---	---	---	---

BS EN1935:2002 Eight Digit Code (page 60 for details)

Brass Hinge

Washed Double Phosphor Bronze

Suitable for medium weight flush doors

Butt hinge	CE certified, Finial
------------	----------------------

Product Features

- Double phosphor bronze tab washed brass butt hinges
- CE and UKCA marked FD30 fire rated
- Brass pin
- 10 year performance guarantee
- Suitable for medium weight flush doors
- Security bolt and radius corner options available

Technical Data	1440 CE	1450 CE
Load capacity (3 Hinges)	40.0	40.0 kg
Overall length	100.0	100.0 mm
Overall width	65.0	75.0 mm
Knuckle diameter	9.2	11.0 mm
Material thickness	3.5	4.0 mm
Screw size (mm)	9.5x32.0	9.5x32.0 mm
Screw size (g)	10.0	10.0 g

Technical Data	1470 CE	1480 CE
Load capacity (3 Hinges)	40.0	40.0 kg
Overall length	127.0	152.4 mm
Overall width	75.0	75.0 mm
Knuckle diameter	11.0	11.0 mm
Material thickness	4.0	4.0 mm
Screw size (mm)	10.9x32.0	10.9x32.0 mm
Screw size (g)	12.0	12.0 g

Finishes

Aged Brass (UK 501), Antique Brass (UK 502), Antique Nickel (UK 503), Copper Bronze (UK 505), Copper (UK 506), Honeycombe (UK 507), Imitation Bronze (UK 508), Midnight (UK 509), Polished Chrome (UK 511), Polished & Lacquered (UK 512), Polished Nickel (UK 513), Satin Brass & Lacquered (UK 514), Satin Chrome (UK 515), Satin Nickel (UK 516), Burnished Brass (UK 522), Polished Imitation Bronze (UK 523)

Note

Supplied complete with Pozi/Slotted Head Brass Woodscrews if required.

Classification key

2	7	2	1	1	4	0	7
---	---	---	---	---	---	---	---

BS EN1935:2002 Eight Digit Code (page 60 for details)

Finial options

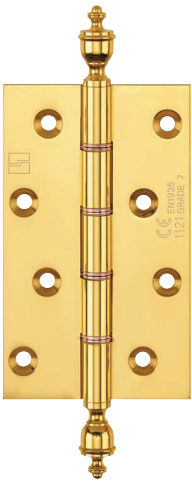

1470 CE

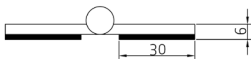
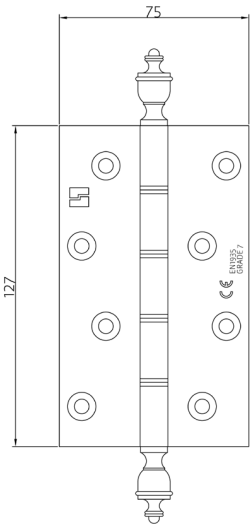

1470 CE with intumescent



P1262

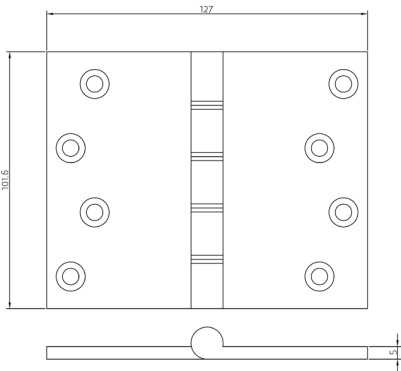

P1262

Brass Hinge

Washed Double Phosphor Bronze

Suitable for medium to heavy weight flush doors

Projection hinge		
------------------	--	--

Product Features

- Double phosphor bronze tab washed brass projection hinges
- Knurled brass plugs for flush end appearance
- Brass pin
- 10 year performance guarantee
- Suitable for medium to heavy weight flush doors
- Security bolt and radius corner options available

Technical Data	P1225	P1260	P1262
Load capacity (3 Hinges)	40.0	40.0	80.0 kg
Overall length	76.2	100.0	101.6 mm
Overall width	75.0	103.2	127.0 mm
Knuckle diameter	11.0	11.0	12.5 mm
Material thickness	4.0	4.0	5.0 mm
Screw size (mm)	9.5x32.0	10.9x32.0	10.9x32.0 mm
Screw size (g)	10.0	12.0	12.0 g
Amount of projection	32.0	50.0	68.0 mm

Technical Data	P1264	P1266	P1275
Load capacity (3 Hinges)	80.0	80.0	40.0 kg
Overall length	101.6	101.6	127.0 mm
Overall width	152.4	203.2	103.2 mm
Knuckle diameter	12.5	12.5	11.0 mm
Material thickness	5.0	5.0	4.0 mm
Screw size (mm)	10.9x32.0	10.9x32.0	10.9x32.0 mm
Screw size (g)	12.0	12.0	12.0 g
Amount of projection	85.0	100.0	50.0 mm

Technical Data	P1285	P1295	P1296
Load capacity (3 Hinges)	40.0	80.0	80.0 kg
Overall length	152.4	152.4	152.4 mm
Overall width	103.2	127.0	152.4 mm
Knuckle diameter	11.0	12.5	12.5 mm
Material thickness	4.0	5.0	5.0 mm
Screw size (mm)	10.9x32.0	10.9x32.0	10.9x32.0 mm
Screw size (g)	12.0	12.0	12.0 g
Amount of projection	50.0	68.0	85.0 mm

Finishes

Aged Brass (UK 501), Antique Brass (UK 502), Antique Nickel (UK 503), Copper Bronze (UK 505), Copper (UK 506), Honeycombe (UK 507), Imitation Bronze (UK 508), Midnight (UK 509), Polished Chrome (UK 511), Polished & Lacquered (UK 512), Polished Nickel (UK 513), Satin Brass & Lacquered (UK 514), Satin Chrome (UK 515), Satin Nickel (UK 516), Burnished Brass (UK 522), Polished Imitation Bronze (UK 523)

Note

Supplied complete with Pozi/Slotted Head Brass Woodscrews if required.
Find out more about projection hinges on page 59.



Brass Hinge

Washed Double Phosphor Bronze

Suitable for medium to heavy weight flush doors

Projection hinge		Finial
------------------	--	--------

Product Features

- Double phosphor bronze tab washed brass projection hinges
- Brass pin
- 10 year performance guarantee
- Suitable for medium to heavy weight flush doors
- Security bolt and radius corner options available

Technical Data	P1460	P1462	P1464
Load capacity (3 Hinges)	40.0	80.0	80.0 kg
Overall length	100.0	101.6	101.6 mm
Overall width	103.2	127.0	152.4 mm
Knuckle diameter	11.0	12.5	12.5 mm
Material thickness	4.0	5.0	5.0 mm
Screw size (mm)	10.9x32.0	10.9x32.0	10.9x32.0 mm
Screw size (g)	12.0	12.0	12.0 g
Amount of projection	50.0	68.0	85.0 mm

Technical Data	P1466	P1475	P1485
Load capacity (3 Hinges)	80.0	40.0	40.0 kg
Overall length	101.6	127.0	152.4 mm
Overall width	203.2	103.2	103.2 mm
Knuckle diameter	12.5	11.0	11.0 mm
Material thickness	5.0	4.0	4.0 mm
Screw size (mm)	10.9x32.0	10.9x32.0	10.9x32.0 mm
Screw size (g)	12.0	12.0	12.0 g
Amount of projection	100.0	50.0	50.0 mm

Finishes

Aged Brass (UK 501), Antique Brass (UK 502), Antique Nickel (UK 503), Copper Bronze (UK 505), Copper (UK 506), Honeycombe (UK 507), Imitation Bronze (UK 508), Midnight (UK 509), Polished Chrome (UK 511), Polished & Lacquered (UK 512), Polished Nickel (UK 513), Satin Brass & Lacquered (UK 514), Satin Chrome (UK 515), Satin Nickel (UK 516), Burnished Brass (UK 522), Polished Imitation Bronze (UK 523)

Note

Supplied complete with Pozi/Slotted Head Brass Woodscrews if required.
Find out more about projection hinges on page 59.

Finial options

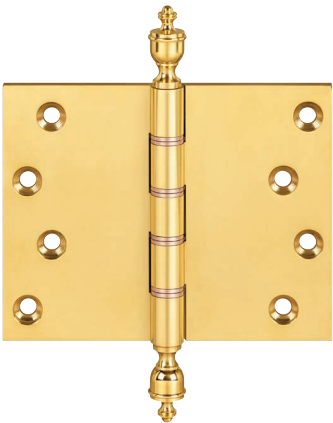

P1462

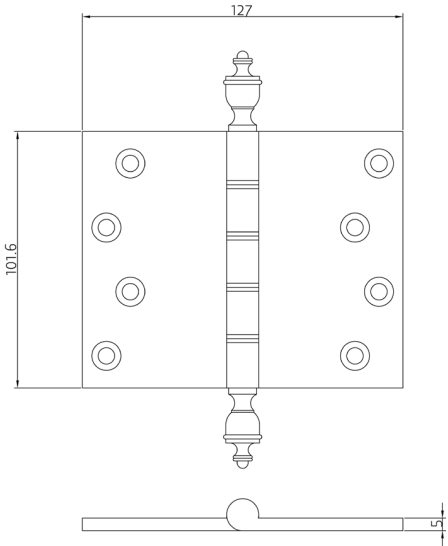

P1462



Brass Hinge

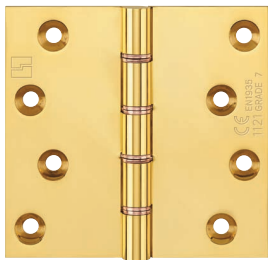

P1260 CE

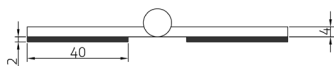
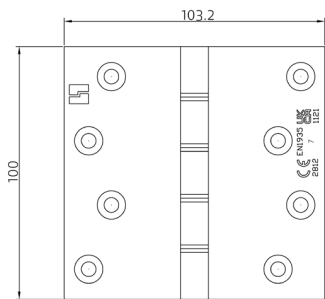

1260 CE with intumescent

Washed Double Phosphor Bronze

Suitable for medium weight flush doors

Projection hinge		CE certified
------------------	--	--------------

Product Features

- Double phosphor bronze tab washed brass projection hinges
- Knurled brass plugs for flush end appearance
- CE and UKCA marked FD30 fire rated
- Brass pin
- 10 year performance guarantee
- Suitable for medium weight flush doors
- Security bolt and radius corner options available

Technical Data	P1260 CE	P1285 CE
Load capacity (3 Hinges)	40.0	40.0 kg
Overall length	100.0	152.4 mm
Overall width	103.2	103.2 mm
Knuckle diameter	11.0	11.0 mm
Material thickness	4.0	4.0 mm
Screw size (mm)	10.9x32.0	10.9x32.0 mm
Screw size (g)	12.0	12.0 g
Amount of projection	50.0	50.0 mm

Finishes

Aged Brass (UK 501), Antique Brass (UK 502), Antique Nickel (UK 503), Copper Bronze (UK 505), Copper (UK 506), Honeycombe (UK 507), Imitation Bronze (UK 508), Midnight (UK 509), Polished Chrome (UK 511), Polished & Lacquered (UK 512), Polished Nickel (UK 513), Satin Brass & Lacquered (UK 514), Satin Chrome (UK 515), Satin Nickel (UK 516), Burnished Brass (UK 522), Polished Imitation Bronze (UK 523)

Note

Supplied complete with Pozi/Slotted Head Brass Woodscrews if required.
Find out more about projection hinges on page 59.

Classification key

2	7	2	1	1	4	0	7
---	---	---	---	---	---	---	---

BS EN1935:2002 Eight Digit Code (page 60 for details)

Brass Hinge

Washed Double Phosphor Bronze

Suitable for medium weight flush doors

Projection hingeCE certified, Finial

Product Features

- Double phosphor bronze tab washed brass projection hinges
- CE and UKCA marked FD30 fire rated
- Brass pin
- 10 year performance guarantee
- Suitable for medium weight flush doors
- Security bolt and radius corner options available

Technical Data	P1460 CE	P1485 CE
Load capacity (3 Hinges)	40.0	40.0 kg
Overall length	100.0	152.4 mm
Overall width	103.2	103.2 mm
Knuckle diameter	11.0	11.0 mm
Material thickness	4.0	4.0 mm
Screw size (mm)	10.9x32.0	10.9x32.0 mm
Screw size (g)	12.0	12.0 g
Amount of projection	50.0	50.0 mm

Finishes

Aged Brass (UK 501), Antique Brass (UK 502), Antique Nickel (UK 503), Copper Bronze (UK 505), Copper (UK 506), Honeycombe (UK 507), Imitation Bronze (UK 508), Midnight (UK 509), Polished Chrome (UK 511), Polished & Lacquered (UK 512), Polished Nickel (UK 513), Satin Brass & Lacquered (UK 514), Satin Chrome (UK 515), Satin Nickel (UK 516), Burnished Brass (UK 522), Polished Imitation Bronze (UK 523)

Note

Supplied complete with Pozi/Slotted Head Brass Woodscrews if required.
Find out more about projection hinges on page 59.

Classification key

2	7	2	1	1	4	0	7
---	---	---	---	---	---	---	---

BS EN1935:2002 Eight Digit Code (page 60 for details)

Finial options

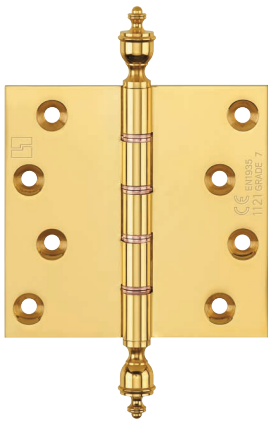

P1460 CE

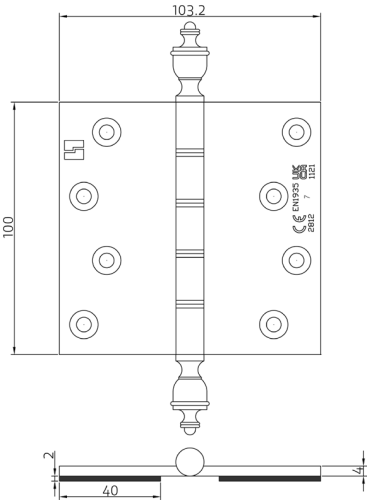

1460 CE with intumescent

Brass Hinge

Ball Race

Suitable for medium to heavy weight flush doors

Butt hinge		
------------	--	--

Product Features

- Brass ball races running in hardened steel cups
- Stainless steel pin
- Brass Button Tip ends
- 10 year performance guarantee
- Suitable for medium to heavy weight flush doors
- Security bolt and radius corner options available

Technical Data	1510	1540	1550
Load capacity (3 Hinges)	40.0	60.0	80.0 kg
Overall length	76.2	100.0	100.0 mm
Overall width	51.2	65.0	75.0 mm
Knuckle diameter	7.8	9.2	11.0 mm
Material thickness	2.9	3.5	4.0 mm
Screw size (mm)	8.1x25.4	9.5x32.0	9.5x32.0 mm
Screw size (g)	8.0	10.0	10.0 g

Technical Data	1570	1580
Load capacity (3 Hinges)	80.0	80.0 kg
Overall length	127.0	152.4 mm
Overall width	75.0	75.0 mm
Knuckle diameter	11.0	11.0 mm
Material thickness	4.0	4.0 mm
Screw size (mm)	10.9x32.0	10.9x32.0 mm
Screw size (g)	12.0	12.0 g

Finishes

Aged Brass (UK 501), Antique Brass (UK 502), Antique Nickel (UK 503), Copper Bronze (UK 505), Copper (UK 506), Honeycombe (UK 507), Imitation Bronze (UK 508), Midnight (UK 509), Polished Chrome (UK 511), Polished & Lacquered (UK 512), Polished Nickel (UK 513), Satin Brass & Lacquered (UK 514), Satin Chrome (UK 515), Satin Nickel (UK 516), Burnished Brass (UK 522), Polished Imitation Bronze (UK 523)

Note

Supplied complete with Pozi/Slotted Head Brass Woodscrews if required.



1550

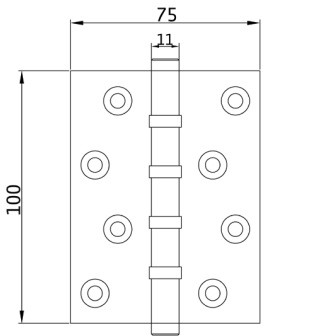

1550

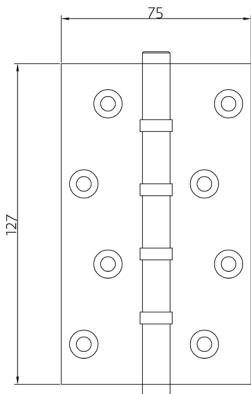

1570



Brass Hinge

Ball Race

Suitable for medium to heavy weight flush doors

Butt hinge		Finial
------------	--	--------

Product Features			
• Brass ball races running in hardened steel cups			
• Stainless steel pin			
• 10 year performance guarantee			
• Suitable for medium to heavy weight flush doors			
• Security bolt and radius corner options available			

Technical Data	1610	1640	1650
Load capacity (3 Hinges)	40.0	60.0	80.0 kg
Overall length	76.2	100.0	100.0 mm
Overall width	51.2	65.0	75.0 mm
Knuckle diameter	7.8	9.2	11.0 mm
Material thickness	2.9	3.5	4.0 mm
Screw size (mm)	8.1x25.4	9.5x32.0	9.5x32.0 mm
Screw size (g)	8.0	10.0	10.0 g

Technical Data	1670	1680
Load capacity (3 Hinges)	80.0	80.0 kg
Overall length	127.0	152.4 mm
Overall width	75.0	75.0 mm
Knuckle diameter	11.0	11.0 mm
Material thickness	4.0	4.0 mm
Screw size (mm)	10.9x32.0	10.9x32.0 mm
Screw size (g)	12.0	12.0 g

Finishes
Aged Brass (UK 501), Antique Brass (UK 502), Antique Nickel (UK 503), Copper Bronze (UK 505), Copper (UK 506), Honeycombe (UK 507), Imitation Bronze (UK 508), Midnight (UK 509), Polished Chrome (UK 511), Polished & Lacquered (UK 512), Polished Nickel (UK 513), Satin Brass & Lacquered (UK 514), Satin Chrome (UK 515), Satin Nickel (UK 516), Burnished Brass (UK 522), Polished Imitation Bronze (UK 523)

Note
Supplied complete with Pozi/Slotted Head Brass Woodscrews if required.

Finial options



1680

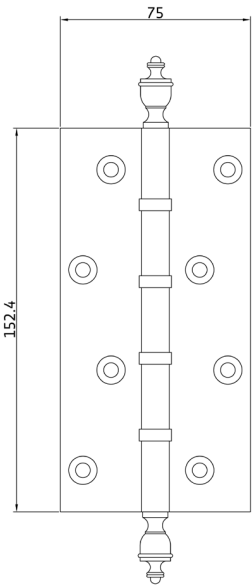

1680



Brass Hinge



1550 CE

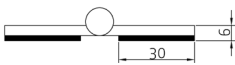
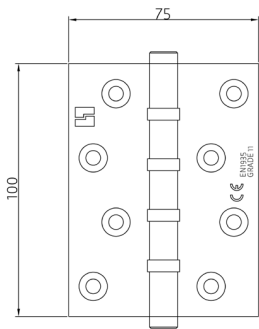

1550 CE with intumescent

Ball Race

Suitable for medium to heavy weight flush doors

Butt hinge	CE certified
------------	--------------

Product Features

- Brass ball races running in hardened steel cups
- CE and UKCA marked FD30 fire rated
- Stainless steel pin
- Brass Button Tip ends
- 10 year performance guarantee
- Suitable for medium to heavy weight flush doors
- Security bolt and radius corner options available

Technical Data	1540 CE	1550 CE
Load capacity (3 Hinges)	60.0	80.0 kg
Overall length	100.0	100.0 mm
Overall width	65.0	75.0 mm
Knuckle diameter	9.2	11.0 mm
Material thickness	3.5	4.0 mm
Screw size (mm)	9.5x32.0	9.5x32.0 mm
Screw size (g)	10.0	10.0 g

Technical Data	1570 CE	1580 CE
Load capacity (3 Hinges)	80.0	80.0 kg
Overall length	127.0	152.4 mm
Overall width	75.0	75.0 mm
Knuckle diameter	11.0	11.0 mm
Material thickness	4.0	4.0 mm
Screw size (mm)	10.9x32.0	10.9x32.0 mm
Screw size (g)	12.0	12.0 g

Finishes

Aged Brass (UK 501), Antique Brass (UK 502), Antique Nickel (UK 503), Copper Bronze (UK 505), Copper (UK 506), Honeycombe (UK 507), Imitation Bronze (UK 508), Midnight (UK 509), Polished Chrome (UK 511), Polished & Lacquered (UK 512), Polished Nickel (UK 513), Satin Brass & Lacquered (UK 514), Satin Chrome (UK 515), Satin Nickel (UK 516), Burnished Brass (UK 522), Polished Imitation Bronze (UK 523)

Note

Supplied complete with Pozi/Slotted Head Brass Woodscrews if required.

Classification key

3	7	4	1	1	4	0	11
---	---	---	---	---	---	---	----

BS EN1935:2002 Eight Digit Code (page 60 for details)



Brass Hinge

Ball Race

Suitable for medium to heavy weight flush doors

Butt hinge	Finial	CE certified
------------	--------	--------------

Product Features

- Brass ball races running in hardened steel cups
- CE and UKCA marked FD30 fire rated
- Stainless steel pin
- 10 year performance guarantee
- Suitable for medium to heavy weight flush doors
- Security bolt and radius corner options available

Technical Data	1640 CE	1650 CE
Load capacity (3 Hinges)	60.0	80.0 kg
Overall length	100.0	100.0 mm
Overall width	65.0	75.0 mm
Knuckle diameter	9.2	11.0 mm
Material thickness	3.5	4.0 mm
Screw size (mm)	9.5x32.0	9.5x32.0 mm
Screw size (g)	10.0	10.0 g

Technical Data	1670 CE	1680 CE
Load capacity (3 Hinges)	80.0	80.0 kg
Overall length	127.0	152.4 mm
Overall width	75.0	75.0 mm
Knuckle diameter	11.0	11.0 mm
Material thickness	4.0	4.0 mm
Screw size (mm)	10.9x32.0	10.9x32.0 mm
Screw size (g)	12.0	12.0 g

Finishes

Aged Brass (UK 501), Antique Brass (UK 502), Antique Nickel (UK 503), Copper Bronze (UK 505), Copper (UK 506), Honeycombe (UK 507), Imitation Bronze (UK 508), Midnight (UK 509), Polished Chrome (UK 511), Polished & Lacquered (UK 512), Polished Nickel (UK 513), Satin Brass & Lacquered (UK 514), Satin Chrome (UK 515), Satin Nickel (UK 516), Burnished Brass (UK 522), Polished Imitation Bronze (UK 523)

Note

Supplied complete with Pozi/Slotted Head Brass Woodscrews if required.

Classification key

3	7	4	1	1	4	0	11
---	---	---	---	---	---	---	----

BS EN1935:2002 Eight Digit Code (page 60 for details)

Finial options



1680 CE

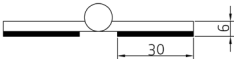
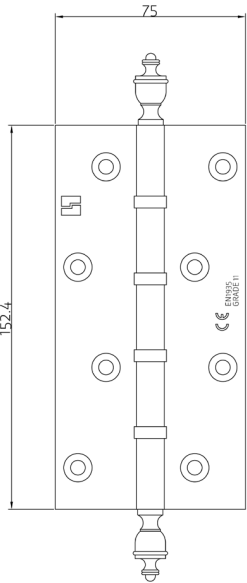

1680 CE with intumescent



P1590

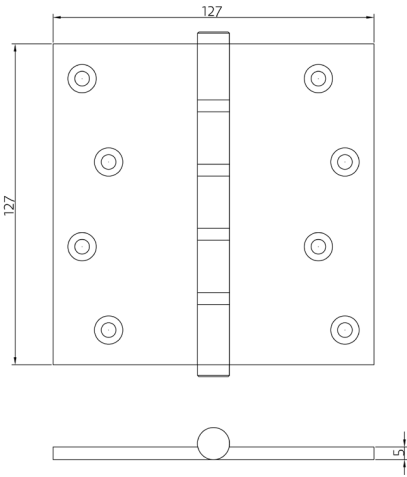

P1590

Brass Hinge

Ball Race

Suitable for medium to heavy weight flush doors

Projection hinge		
Product Features		
<ul style="list-style-type: none">• Brass ball races running in hardened steel cups• Stainless steel pin• Brass Button Tip ends• 10 year performance guarantee• Suitable for medium to heavy weight flush doors• Security bolt and radius corner options available		

Technical Data	P1560	P1562	P1564
Load capacity (3 Hinges)	80.0	80.0	80.0 kg
Overall length	100.0	101.6	101.6 mm
Overall width	103.2	127.0	152.4 mm
Knuckle diameter	11.0	12.5	12.5 mm
Material thickness	4.0	5.0	5.0 mm
Screw size (mm)	10.9x32.0	10.9x32.0	10.9x32.0 mm
Screw size (g)	12.0	12.0	12.0 g
Amount of projection	50.0	68.0	85.0 mm

Technical Data	P1566	P1575	P1585
Load capacity (3 Hinges)	80.0	80.0	80.0 kg
Overall length	101.6	127.0	152.4 mm
Overall width	203.2	103.2	103.2 mm
Knuckle diameter	12.5	11.0	11.0 mm
Material thickness	5.0	4.0	4.0 mm
Screw size (mm)	10.9x32.0	10.9x32.0	10.9x32.0 mm
Screw size (g)	12.0	12.0	12.0 g
Amount of projection	100.0	50.0	50.0 mm

Technical Data	P1590	P1595
Load capacity (3 Hinges)	80.0	80.0 kg
Overall length	127.0	152.4 mm
Overall width	127.0	127.0 mm
Knuckle diameter	12.7	12.7 mm
Material thickness	5.0	5.0 mm
Screw size (mm)	10.9x32.0	10.9x32.0 mm
Screw size (g)	12.0	12.0 g
Amount of projection	68.0	68.0 mm

Finishes

Aged Brass (UK 501), Antique Brass (UK 502), Antique Nickel (UK 503), Copper Bronze (UK 505), Copper (UK 506), Honeycombe (UK 507), Imitation Bronze (UK 508), Midnight (UK 509), Polished Chrome (UK 511), Polished & Lacquered (UK 512), Polished Nickel (UK 513), Satin Brass & Lacquered (UK 514), Satin Chrome (UK 515), Satin Nickel (UK 516), Burnished Brass (UK 522), Polished Imitation Bronze (UK 523)

Note

Supplied complete with Pozi/Slotted Head Brass Woodscrews if required.
Find out more about projection hinges on page 59.



Brass Hinge

Ball Race

Suitable for medium to heavy weight flush doors

Projection hinge		Finial
------------------	--	--------

Product Features

- Brass ball races running in hardened steel cups
- Stainless steel pin
- 10 year performance guarantee
- Suitable for medium to heavy weight flush doors
- Security bolt and radius corner options available

Technical Data	P1660	P1662	P1664
Load capacity (3 Hinges)	80.0	80.0	80.0 kg
Overall length	100.0	101.6	101.6 mm
Overall width	103.2	127.0	152.4 mm
Knuckle diameter	11.0	12.5	12.5 mm
Material thickness	4.0	5.0	5.0 mm
Screw size (mm)	10.9x32.0	10.9x32.0	10.9x32.0 mm
Screw size (g)	12.0	12.0	12.0 g
Amount of projection	50.0	68.0	85.0 mm

Technical Data	P1666	P1675	P1685
Load capacity (3 Hinges)	80.0	80.0	80.0 kg
Overall length	101.6	127.0	152.4 mm
Overall width	203.2	103.2	103.2 mm
Knuckle diameter	12.5	11.0	11.0 mm
Material thickness	5.0	4.0	4.0 mm
Screw size (mm)	10.9x32.0	10.9x32.0	10.9x32.0 mm
Screw size (g)	12.0	12.0	12.0 g
Amount of projection	100.0	50.0	50.0 mm

Finishes

Aged Brass (UK 501), Antique Brass (UK 502), Antique Nickel (UK 503), Copper Bronze (UK 505), Copper (UK 506), Honeycombe (UK 507), Imitation Bronze (UK 508), Midnight (UK 509), Polished Chrome (UK 511), Polished & Lacquered (UK 512), Polished Nickel (UK 513), Satin Brass & Lacquered (UK 514), Satin Chrome (UK 515), Satin Nickel (UK 516), Burnished Brass (UK 522), Polished Imitation Bronze (UK 523)

Note

Supplied complete with Pozi/Slotted Head Brass Woodscrews if required.
Find out more about projection hinges on page 59.

Finial options

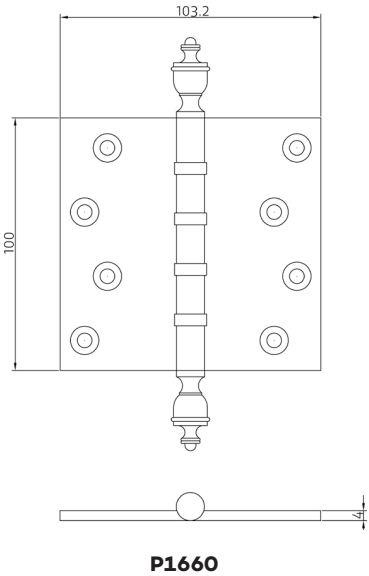

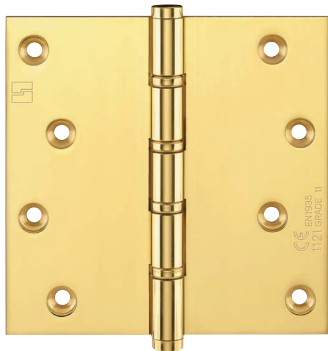

P1590 CE

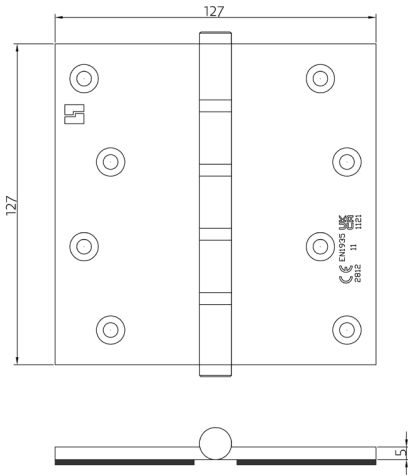

P1590 CE with intumescent

Brass Hinge

Ball Race

Suitable for medium to heavy weight flush doors

Projection hinge		CE certified
------------------	--	--------------

Product Features

- Brass ball races running in hardened steel cups
- CE and UKCA marked FD30 fire rated
- Stainless steel pin
- Brass Button Tip ends
- 10 year performance guarantee
- Suitable for medium to heavy weight flush doors
- Security bolt and radius corner options available

Technical Data	P1560 CE	P1585 CE
Load capacity (3 Hinges)	80.0	80.0 kg
Overall length	100.0	152.4 mm
Overall width	103.2	103.2 mm
Knuckle diameter	11.0	11.0 mm
Material thickness	4.0	4.0 mm
Screw size (mm)	10.9x32.0	10.9x32.0 mm
Screw size (g)	12.0	12.0 g
Amount of projection	50.0	50.0 mm

Technical Data	P1590 CE	P1595 CE
Load capacity (3 Hinges)	80.0	80.0 kg
Overall length	127.0	152.4 mm
Overall width	127.0	127.0 mm
Knuckle diameter	12.7	12.7 mm
Material thickness	5.0	5.0 mm
Screw size (mm)	10.9x32.0	10.9x32.0 mm
Screw size (g)	12.0	12.0 g
Amount of projection	68.0	68.0 mm

Finishes

Aged Brass (UK 501), Antique Brass (UK 502), Antique Nickel (UK 503), Copper Bronze (UK 505), Copper (UK 506), Honeycombe (UK 507), Imitation Bronze (UK 508), Midnight (UK 509), Polished Chrome (UK 511), Polished & Lacquered (UK 512), Polished Nickel (UK 513), Satin Brass & Lacquered (UK 514), Satin Chrome (UK 515), Satin Nickel (UK 516), Burnished Brass (UK 522), Polished Imitation Bronze (UK 523)

Note

Supplied complete with Pozi/Slotted Head Brass Woodscrews if required.
Find out more about projection hinges on page 59.

Classification key

3	7	4	1	1	4	0	11
---	---	---	---	---	---	---	----

BS EN1935:2002 Eight Digit Code (page 60 for details)

Brass Hinge

Ball Race

Suitable for medium to heavy weight flush doors

Projection hinge	Finial	CE certified
------------------	--------	--------------

Product Features

- Brass ball races running in hardened steel cups
- CE and UKCA marked FD30 fire rated
- Stainless steel pin
- 10 year performance guarantee
- Suitable for medium to heavy weight flush doors
- Security bolt and radius corner options available

Technical Data	P1660 CE	P1685 CE
Load capacity (3 Hinges)	80.0	80.0 kg
Overall length	100.0	152.4 mm
Overall width	103.2	103.2 mm
Knuckle diameter	11.0	11.0 mm
Material thickness	4.0	4.0 mm
Screw size (mm)	10.9x32.0	10.9x32.0 mm
Screw size (g)	12.0	12.0 g
Amount of projection	50.0	50.0 mm

Finishes

Aged Brass (UK 501), Antique Brass (UK 502), Antique Nickel (UK 503), Copper Bronze (UK 505), Copper (UK 506), Honeycombe (UK 507), Imitation Bronze (UK 508), Midnight (UK 509), Polished Chrome (UK 511), Polished & Lacquered (UK 512), Polished Nickel (UK 513), Satin Brass & Lacquered (UK 514), Satin Chrome (UK 515), Satin Nickel (UK 516), Burnished Brass (UK 522), Polished Imitation Bronze (UK 523)

Note

Supplied complete with Pozi/Slotted Head Brass Woodscrews if required.
Find out more about projection hinges on page 59.

Classification key

3	7	4	1	1	4	0	11
---	---	---	---	---	---	---	----

BS EN1935:2002 Eight Digit Code (page 60 for details)

Finial options

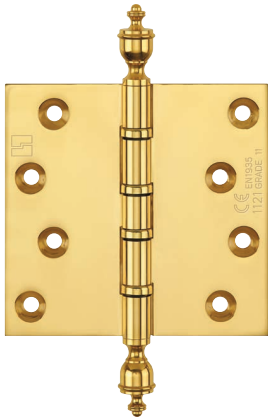

P1660 CE

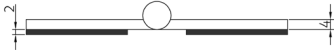
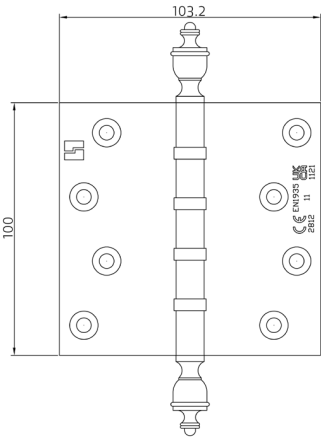

P1660 CE with intumescent

Brass Hinge

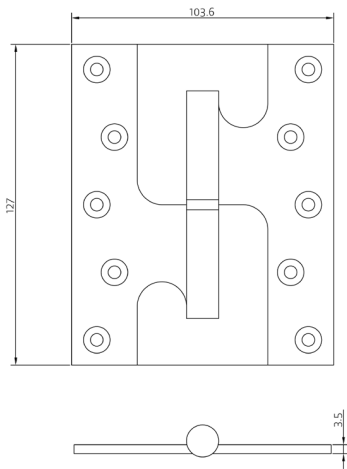
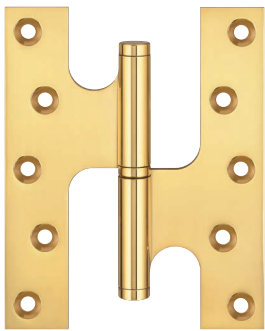

Paumelle hinge

Suitable for medium weight flush doors

Hinge		
-------	--	--

Product Features

- Solid brass lift off hinge
- Weight carrying capacity to 60 kg
- Suitable for medium weight flush doors
- Decorative finial options available
- Handed left or right - see figure 2 on page 65

Technical Data	1360
Load capacity (3 Hinges)	60.0 kg
Knuckle diameter	12.7 mm
Overall length	127.0 mm
Overall width	103.2 mm
Material thickness	3.5 mm
Screw size (mm)	9.5x32.0 mm
Screw size (g)	10.0 g

Finishes

Aged Brass (UK 501), Antique Brass (UK 502), Antique Nickel (UK 503), Copper Bronze (UK 505), Copper (UK 506), Honeycombe (UK 507), Imitation Bronze (UK 508), Midnight (UK 509), Polished Chrome (UK 511), Polished & Lacquered (UK 512), Polished Nickel (UK 513), Satin Brass & Lacquered (UK 514), Satin Chrome (UK 515), Satin Nickel (UK 516), Burnished Brass (UK 522), Polished Imitation Bronze (UK 523)

Note

Brass pozi-drive and slotted head and woodscrews available.

Finial options



Stainless Steel Hinge

Rising hinge

Suitable for medium weight toilet cubicle and internal flush doors

Hinge		
Product Features		
• Rise or fall of 8 mm at 180°		
• Stainless steel pin		
• Handed left or right - see figure 2 on page 65		
• Low cost hinges		
• Grade 304 Stainless Steel		

Technical Data	1940
Load capacity (3 Hinges)	40.0 kg
Overall length	102.0 mm
Overall width	76.0 mm
Knuckle diameter	14.0 mm
Material thickness	3.0 mm
Screw size (mm)	9.5x32.0 mm
Screw size (g)	10.0 g

Finishes
Satin Stainless Steel, Bright Polished Stainless Steel

Note
Supplied complete with fixing screws.
10 year guarantee does not apply.

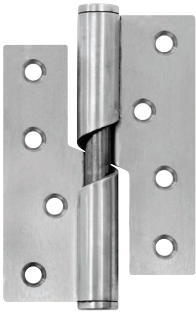

1940

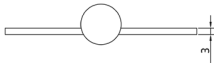
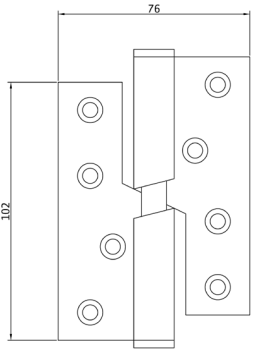

1940

Stainless Steel Hinge

Falling hinge

Suitable for medium weight toilet cubicle and internal flush doors

Hinge		
-------	--	--

Product Features

- Rise or fall of 8 mm at 180°
- Stainless steel pin
- Handed left or right - see figure 2 on page 65
- Low cost hinges
- Grade 304 Stainless Steel

Technical Data	1941
Load capacity (3 Hinges)	40.0 kg
Overall length	102.0 mm
Overall width	76.0 mm
Knuckle diameter	14.0 mm
Material thickness	3.0 mm
Screw size (mm)	9.5x32.0 mm
Screw size (g)	10.0 g

Finishes

Satin Stainless Steel, Bright Polished Stainless Steel

Note

Supplied complete with fixing screws.
10 year guarantee does not apply.



1941

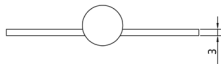
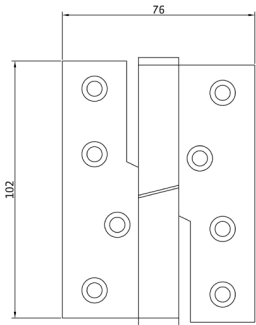

1941

Stainless Steel Hinge

Spring hinge

Suitable for medium weight internal flush doors

Double action hinge

Product Features

- Adjustable spring tension
- Grade 304 Stainless Steel
- Supplied with complete set of fitting instructions
- Double action, door swings both ways and returns to closing position

Technical Data	0101
Load capacity (2 Hinges)	25.0 kg
Overall length	100.0 mm
Knuckle diameter	21.0 mm
Material thickness	34.0 mm
Screw size (mm)	6.7x19.0 mm
Screw size (g)	6.0 g

Technical Data	0101	0101
Load capacity (2 Hinges)	30.0	45.0 kg
Overall length	125.0	150.0 mm
Knuckle diameter	21.0	21.0 mm
Material thickness	45.0	45.0 mm
Screw size (mm)	8.1x25.4	8.1x25.4 mm
Screw size (g)	8.0	8.0 g

Finishes

Satin Stainless Steel

Note

Supplied complete with fixing screws.
10 year guarantee does not apply.

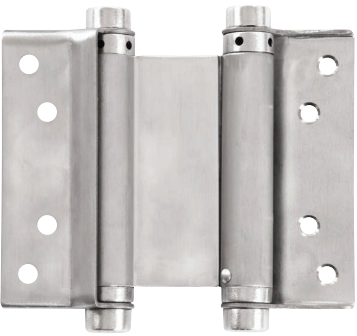

0101

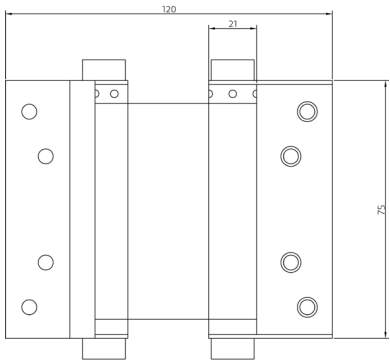

0101

Steel Hinge

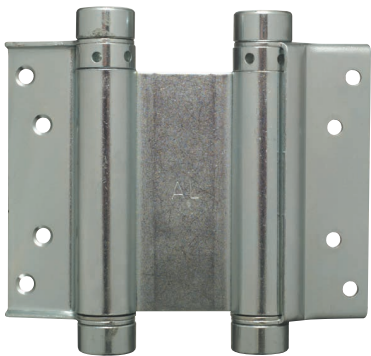

0101

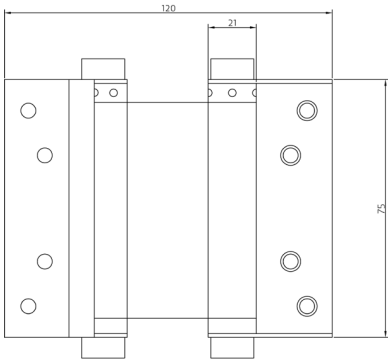

0101

Spring hinge

Suitable for medium weight internal flush doors

Double action hinge		
---------------------	--	--

Product Features

- Adjustable spring tension
- Supplied with complete set of fitting instructions
- Double action, door swings both ways and returns to closing position

Technical Data	0101
Load capacity (2 Hinges)	25.0 kg
Overall length	100.0 mm
Knuckle diameter	21.0 mm
Material thickness	34.0 mm
Screw size (mm)	6.7x19.0 mm
Screw size (g)	6.0 g

Technical Data	0101	0101
Load capacity (2 Hinges)	30.0	45.0 kg
Overall length	125.0	150.0 mm
Knuckle diameter	21.0	21.0 mm
Material thickness	45.0	45.0 mm
Screw size (mm)	8.1x25.4	8.1x25.4 mm
Screw size (g)	8.0	8.0 g

Finishes

Zinc plated

Note

Supplied complete with fixing screws.
10 year guarantee does not apply.

Aluminium Hinge

Washed Single Delrin

Suitable for light weight flush doors

Butt hinge		
Product Features		
<ul style="list-style-type: none">• Delrin washed aluminium butt hinges• Aluminium pin• 10 year performance guarantee• Suitable for light weight flush doors		

Technical Data	2110	2140	2150
Load capacity (3 Hinges)	20.0	20.0	20.0 kg
Overall length	75.0	100.0	100.0 mm
Overall width	50.0	65.0	75.0 mm
Knuckle diameter	10.0	11.0	11.0 mm
Material thickness	3.0	4.0	4.0 mm
Screw size (mm)	8.1x25.4	9.5x32.0	9.5x32.0 mm
Screw size (g)	8.0	10.0	10.0 g

Finishes
Etched and Anodised, Polished and Anodised

Note
Other anodised finishes available on request.
Supplied complete with Pozi Head Steel Zinc Plated Woodscrews if required.



2140

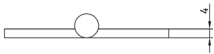
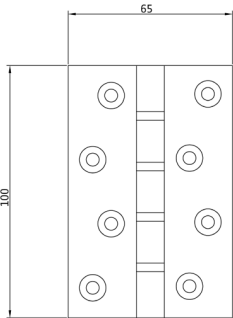

2140

Washed Double Stainless Steel

Suitable for light to medium weight flush doors

Butt hinge		
Product Features		
<ul style="list-style-type: none">• Double stainless steel tab washed aluminium butt hinges• Knurled aluminium plugs for flush end appearance• Stainless steel pin• 10 year performance guarantee• Suitable for light weight flush doors		

Technical Data	2010	2040	2050
Load capacity (3 Hinges)	20.0	40.0	40.0 kg
Overall length	75.0	100.0	100.0 mm
Overall width	50.0	65.0	75.0 mm
Knuckle diameter	10.0	11.0	11.0 mm
Material thickness	3.0	4.0	4.0 mm
Screw size (mm)	8.1x25.4	9.5x32.0	9.5x32.0 mm
Screw size (g)	8.0	10.0	10.0 g

Finishes
Etched and Anodised, Polished and Anodised

Note
Other anodised finishes available on request.
Supplied complete with Pozi Head Steel Zinc Plated Woodscrews if required.



2050

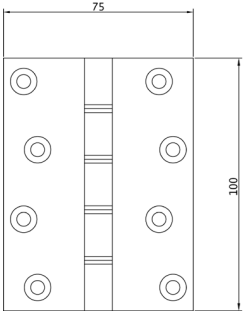

2050



Nylon Hinge

Unwashed

Suitable for very light weight doors

Butt hinge		
------------	--	--

Product Features

- Zinc plated steel pin
- Suitable for very light weight doors
- Useful in areas which need regular cleaning/decontamination

Technical Data	3205
Load capacity (3 Hinges)	10.0 kg
Overall length	75.0 mm
Overall width	50.0 mm
Knuckle diameter	8.0 mm
Material thickness	3.0/4.0 mm
Screw size (mm)	7.4x19.0 mm
Screw size (g)	7.0 g

Finishes

Natural

Note

Steel zinc plated fixing screws available if required.
10 year guarantee does not apply.



3205

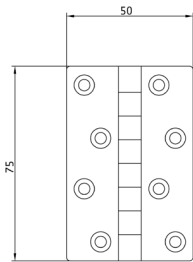

3205

Hardware

Edge Pull

The solid brass edge pulls are ideal for use on drawers and various door types. With a simple modern design they will compliment any style of furniture and room. The edge pull is suitable for 18 mm and 44 mm+ thick profiles and are available in standard and bespoke lengths in a wide range of finishes including PVD. The PVD finishes have an abrasion and tarnish resistant surface with salt spray tests achieved for over 1,000 hours.



Robe Hook

The solid brass robe hook collection is ideal for a wide range of uses. The range consisting of both robe hooks and wardrobe hooks will suite any décor from traditional to modern. The new stylish designs offer a solution for all types of interior designs and are available in a wide range of finishes including PVD.





0012

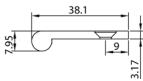

0012



8001

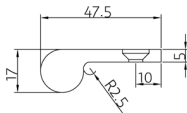

8001

Edge Pull

Brass

Suitable for 18 mm thick profiles

Round flat design		Small
-------------------	--	-------

Product Features

- Solid brass edge pulls for use on drawers and various door types
- Simple modern design that will compliment any style of furniture
- Available in standard 50 mm, 75 mm, 100 mm and 200 mm sizes
- Various finishes including standard and PVD

Technical Data	0012
Suitable Profile Size	18.0 mm
Overall length	50.0 / 75.0 / 100.0 / 200.0 mm
Knuckle diameter	7.95 mm
Screw size (mm)	8.1x25.4 mm
Screw size (g)	8.0 g

Edge Pull

Suitable for 18 mm thick profiles

Round flat design		Small
-------------------	--	-------

Product Features

- Solid brass edge pulls for use on drawers and various door types
- Simple modern design that will compliment any style of furniture
- Available in standard 50 mm, 75 mm, 100 mm and 200 mm sizes
- Various finishes including standard and PVD

Technical Data	8001
Knuckle diameter	17.0 mm
Overall length	50.0 / 75.0 / 100.0 / 200.0 mm
Screw size (mm)	9.5x32.0 mm
Screw size (g)	10.0 g

Finishes

Aged Brass (UK 501), Antique Brass (UK 502), Antique Nickel (UK 503), Copper Bronze (UK 505), Copper (UK 506), Honeycombe (UK 507), Imitation Bronze (UK 508), Midnight (UK 509), Polished Chrome (UK 511), Polished & Lacquered (UK 512), Polished Nickel (UK 513), Satin Brass & Lacquered (UK 514), Satin Chrome (UK 515), Satin Nickel (UK 516), Burnished Brass (UK 522), Polished Imitation Bronze (UK 523)

PVD Finishes: PVD Brass (UK 517), PVD Copper Rose (UK 518), PVD Matt Black (UK 519), PVD Rainbow (UK 520), PVD Stainless Steel Effect (UK 521)

Salt spray tested to over 1,000 hours

Note

Supplied with brass Pozi-drive head woodscrews.
Bespoke length and sizes, prices on application.
Salt spray tested to over 1,000 hours.

Edge Pull

Brass

Suitable for 44 mm thick profiles

Round flat design		Large
-------------------	--	-------

Product Features

- Solid brass edge pulls for use on drawers and various door types
- Simple modern design that will compliment any style of furniture
- Available in standard 50 mm, 75 mm, 100 mm and 200 mm sizes
- Various finishes including standard and PVD

Technical Data	0039
Suitable Profile Size	44.0 mm
Overall length	50.0 / 75.0 / 100.0 / 200.0 mm
Knuckle diameter	9.52 mm
Screw size (mm)	9.5x32.0 mm
Screw size (g)	10.0 g



0039

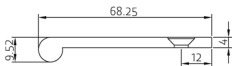

0039

Brass

Suitable for 18 mm thick profiles

Round flat design		With angle return
-------------------	--	-------------------

Product Features

- Solid brass edge pulls for use on drawers and various door types
- Simple modern design that will compliment any style of furniture
- Available in standard 50 mm, 75 mm, 100 mm and 200 mm sizes
- Various finishes including standard and PVD

Technical Data	0082
Suitable Profile Size	18.0 mm
Overall length	50.0 / 75.0 / 100.0 / 200.0 mm
Knuckle diameter	8.0 mm
Screw size (mm)	8.1x25.4 mm
Screw size (g)	8.0 g

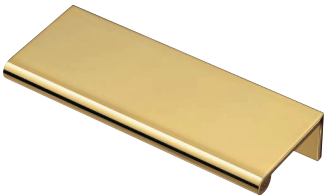

0082

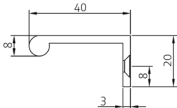

0082

Finishes

Aged Brass (UK 501), Antique Brass (UK 502), Antique Nickel (UK 503), Copper Bronze (UK 505), Copper (UK 506), Honeycombe (UK 507), Imitation Bronze (UK 508), Midnight (UK 509), Polished Chrome (UK 511), Polished & Lacquered (UK 512), Polished Nickel (UK 513), Satin Brass & Lacquered (UK 514), Satin Chrome (UK 515), Satin Nickel (UK 516), Burnished Brass (UK 522), Polished Imitation Bronze (UK 523)

PVD Finishes: PVD Brass (UK 517), PVD Copper Rose (UK 518), PVD Matt Black (UK 519), PVD Rainbow (UK 520), PVD Stainless Steel Effect (UK 521)
Salt spray tested to over 1,000 hours

Note

Supplied with brass Pozi-drive head woodscrews.
Bespoke length and sizes, prices on application.

Edge Pull

Brass

Suitable for 44 mm thick profiles

Round flat design		With angle return
-------------------	--	-------------------

Product Features

- Solid brass edge pulls for use on drawers and various door types
- Simple modern design that will compliment any style of furniture
- Available in standard 50 mm, 75 mm, 100 mm and 200 mm sizes
- Various finishes including standard and PVD

Technical Data	0081
Suitable Profile Size	44.0 mm
Overall length	50.0 / 75.0 / 100.0 / 200.0 mm
Knuckle diameter	10.0 mm
Screw size (mm)	9.5x32.0 mm
Screw size (g)	10.0 g



0081

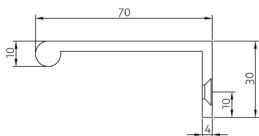

0081



0080

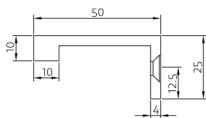

0080

Brass

Suitable for 18 mm thick profiles

Cube edge design		With radius angle return
------------------	--	--------------------------

Product Features

- Solid brass edge pulls for use on drawers and various door types
- Simple modern design that will compliment any style of furniture
- Available in standard 50 mm, 75 mm, 100 mm and 200 mm sizes
- Various finishes including standard and PVD

Technical Data	0080
Suitable Profile Size	18.0 mm
Overall length	50.0 / 75.0 / 100.0 / 200.0 mm
Knuckle diameter	10.0 mm
Screw size (mm)	8.1x25.4 mm
Screw size (g)	8.0 g

Finishes

Aged Brass (UK 501), Antique Brass (UK 502), Antique Nickel (UK 503), Copper Bronze (UK 505), Copper (UK 506), Honeycombe (UK 507), Imitation Bronze (UK 508), Midnight (UK 509), Polished Chrome (UK 511), Polished & Lacquered (UK 512), Polished Nickel (UK 513), Satin Brass & Lacquered (UK 514), Satin Chrome (UK 515), Satin Nickel (UK 516), Burnished Brass (UK 522), Polished Imitation Bronze (UK 523)

PVD Finishes: PVD Brass (UK 517), PVD Copper Rose (UK 518), PVD Matt Black (UK 519), PVD Rainbow (UK 520), PVD Stainless Steel Effect (UK 521)
Salt spray tested to over 1,000 hours

Note

Supplied with brass Pozi-drive head woodscrews.
Bespoke length and sizes, prices on application.

Edge Pull

Brass

Suitable for 44 mm thick profiles

Cube edge design		
Product Features		
<ul style="list-style-type: none">• Solid brass edge pulls for use on drawers and various door types• Simple modern design that will compliment any style of furniture• Available in standard 50 mm, 75 mm, 100 mm and 200 mm sizes• Various finishes including standard and PVD		

Technical Data	0085
Suitable Profile Size	44.0 mm
Overall length	50.0 / 75.0 / 100.0 / 200.0 mm
Knuckle diameter	10.0 mm
Screw size (mm)	9.5x32.0 mm
Screw size (g)	10.0 g



0085

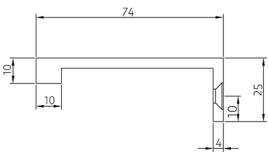

0085

Brass

Suitable for 18 mm thick profiles

Cube edge design		
Product Features		
<ul style="list-style-type: none">• Solid brass edge pulls for use on drawers and various door types• Simple modern design that will compliment any style of furniture• Available in standard 50 mm, 75 mm, 100 mm and 200 mm sizes• Various finishes including standard and PVD		

Technical Data	0079
Suitable Profile Size	18.0 mm
Overall length	50.0 / 75.0 / 100.0 / 200.0 mm
Knuckle diameter	9.5 mm
Screw size (mm)	8.1x25.4 mm
Screw size (g)	8.0 g



0079

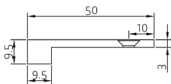

0079

Finishes
Aged Brass (UK 501), Antique Brass (UK 502), Antique Nickel (UK 503), Copper Bronze (UK 505), Copper (UK 506), Honeycombe (UK 507), Imitation Bronze (UK 508), Midnight (UK 509), Polished Chrome (UK 511), Polished & Lacquered (UK 512), Polished Nickel (UK 513), Satin Brass & Lacquered (UK 514), Satin Chrome (UK 515), Satin Nickel (UK 516), Burnished Brass (UK 522), Polished Imitation Bronze (UK 523)

PVD Finishes: PVD Brass (UK 517), PVD Copper Rose (UK 518), PVD Matt Black (UK 519), PVD Rainbow (UK 520), PVD Stainless Steel Effect (UK 521)
Salt spray tested to over 1,000 hours

Note
Supplied with brass Pozi-drive head woodscrews.
Bespoke length and sizes, prices on application.



0088

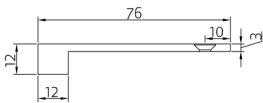

0088



0087

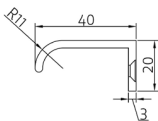

0087

Edge Pull

Brass

Suitable for 44 mm thick profiles

Cube edge design

Product Features

- solid brass edge pulls for use on drawers and various door types
- simple modern design that will compliment any style of furniture
- available in standard 50 mm, 75 mm, 100 mm and 200 mm sizes
- various finishes including standard and PVD

Technical Data

0088

Suitable Profile Size	44.0 mm
Overall length	50.0 / 75.0 / 100.0 / 200.0 mm
Knuckle diameter	18.0 mm
Screw size (mm)	9.5x32.0 mm
Screw size (g)	10.0 g

Brass

Suitable for 18 mm thick profiles

Curved edge design

Product Features

- Solid brass edge pulls for use on drawers and various door types
- Simple modern design that will compliment any style of furniture
- Available in standard 50 mm, 75 mm, 100 mm and 200 mm sizes
- Various finishes including standard and PVD

Technical Data

0087

Suitable Profile Size	18.0 mm
Overall length	50.0 / 75.0 / 100.0 / 200.0 mm
Screw size (mm)	8.1x25.4 mm
Screw size (g)	8.0 g

Finishes

Aged Brass (UK 501), Antique Brass (UK 502), Antique Nickel (UK 503), Copper Bronze (UK 505), Copper (UK 506), Honeycombe (UK 507), Imitation Bronze (UK 508), Midnight (UK 509), Polished Chrome (UK 511), Polished & Lacquered (UK 512), Polished Nickel (UK 513), Satin Brass & Lacquered (UK 514), Satin Chrome (UK 515), Satin Nickel (UK 516), Burnished Brass (UK 522), Polished Imitation Bronze (UK 523)

PVD Finishes: PVD Brass (UK 517), PVD Copper Rose (UK 518), PVD Matt Black (UK 519), PVD Rainbow (UK 520), PVD Stainless Steel Effect (UK 521)

Salt spray tested to over 1,000 hours

Note

Supplied with brass Pozi-drive head woodscrews.
Bespoke length and sizes, prices on application.
Salt spray tested to over 1,000 hours.

Robe Hook

Brass

for use on various wall and door types

Robe Hook		
Product Features		
<ul style="list-style-type: none">• Solid brass robe hooks for use on wall and door types• Simple modern design that will complement any interior design• Concealed fixings• Various finishes including standard and PVD		
Technical Data		
		6700
Overall length		26.0 mm

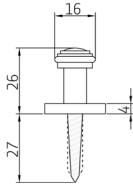

Brass

for use on various wall and door types

Robe Hook		
Product Features		
<ul style="list-style-type: none">• Solid brass robe hooks for use on wall and door types• Simple modern design that will complement any interior design• Concealed fixings• Various finishes including standard and PVD		
Technical Data		
		6710
Overall length		24.0 mm

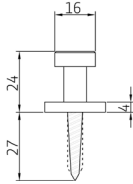

Finishes
Aged Brass (UK 501), Antique Brass (UK 502), Antique Nickel (UK 503), Copper Bronze (UK 505), Copper (UK 506), Honeycombe (UK 507), Imitation Bronze (UK 508), Midnight (UK 509), Polished Chrome (UK 511), Polished & Lacquered (UK 512), Polished Nickel (UK 513), Satin Brass & Lacquered (UK 514), Satin Chrome (UK 515), Satin Nickel (UK 516), Burnished Brass (UK 522), Polished Imitation Bronze (UK 523)

PVD Finishes: PVD Brass (UK 517), PVD Copper Rose (UK 518), PVD Matt Black (UK 519), PVD Rainbow (UK 520), PVD Stainless Steel Effect (UK 521)

Salt spray tested to over 1,000 hours

Note
Supplied as one robe hook complete with fixing.
Salt spray tested to over 1,000 hours.

Magnetic Touch Latch

Ref. 0020MC

for premium flush doors

Magnetic Touch Latch		
----------------------	--	--

Product Features

- 5.44 kg opening force (opens full-sized doors)
- Available in black or aluminium finish
- Travel required to unlock = 2 mm
- Strike plate included

Technical Data

	0020MC
Overall length	79.0 mm
Overall width	57.2 mm
Overall depth	17.5 mm

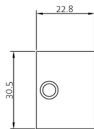
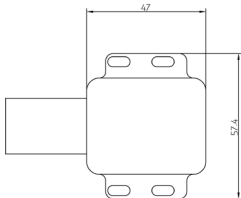
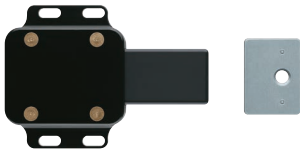

Finishes

Please note: The colours of the finishes shown may differ from the original.
More finishes upon request.

STANDARD FINISHES



Aged Brass



Antique Brass



Antique Nickel



Burnished Brass



Copper Bronze



Copper



Honeycombe



Imitation Bronze
Metal Antique



Midnight



Polished Chrome



Polished Brass

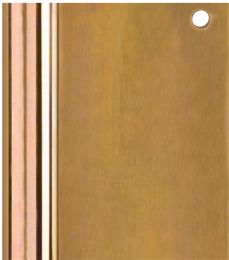

Polished Imitation
Bronze



Polished Nickel



Satin Brass Lacquered



Satin Chrome



Satin Nickel

Care of Finishes

1. Regular cleaning with a cloth damped with good light oil or lanolin should be enough to keep all finishes in its original condition for a long period.

2. For extra cleaning of polished and lacquered finishes it is recommend that a good quality wax polish is used, particularly on externally fitted items, applied every few weeks.

3. Some lacquered finishes can break down eventually due to adverse conditions. Therefore the
- life of all finishes is beyond our control and cannot be guaranteed.

4. For more information regarding salt spray corrosion testing on certain finishes to BS EN 1670 please contact your distributor or the manufacturer.

5. Do not use Solvents, cleaning chemicals or abrasive products on surface finishes.

6. Do not apply adhesive tapes to any surface finishes.

PVD FINISHES



Brass



Copper Rose

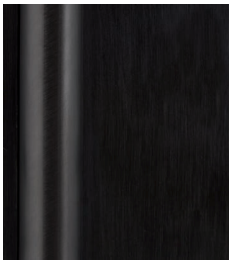

Matt Black

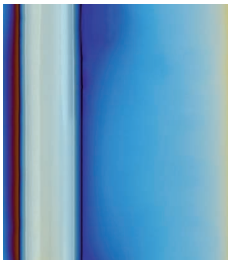

Rainbow



Stainless Steel Effect

Technical Information

UK GUARANTEES

All our hinges are given a recommended weight loading based on three hinges per door leaf. Products which are covered under the 10 or 25 year performance guarantee are indicated with the relevant logo. The Guarantee will only apply if the hinges have been fitted in accordance with the fitting instructions enclosed in every box of hinges.

For assistance on which type of hinge to use regarding door weight and size please contact our Sales Department.

See website for further information.

HINGE TYPES

Brass	Produced to precise standards, in a wide range of anti-bacterial quality finishes for trouble free use. Suitable for fire doors where indicated.
Aluminium	High standard hinges in a variety of finishes. Not suitable for fire doors.
Projection	The P symbol shown next to various hinge reference numbers throughout the catalogue identifies projection hinges which are drilled with holes towards the edge of a broad hinge leaf enabling the hinge to clear obstructions when fully opened beyond 90°.

SELECTION – Refer to Technical Section

When deciding on finish and the best hinge for each application take into account adjusted door weight; appearance to match both the environment and product; position of doors or windows within a building and direction of opening; type of building use e.g. hospital and its location e.g. coastal environments need special consideration as certain finishes are not suitable; frequency of use; security and fire resistance requirements.

SPECIFICATION

CE Marking – To comply with the new UK Construction Products Regulations CE marking is required for hinges used on fire, smoke and escape route doors. Hinges marked in the catalogue with a CE Reference have been successfully performance tested and also where indicated fire tested up to 30 minutes and 1 hr respectively.

European Standards – Hinges detailed in this catalogue comply as required to the European Standard BS/EN 1935 : 2002. The standard covers Building Hardware – Single-Axis Hinges – Requirements and Test Methods as detailed in table A shown in the Technical Section.

Building Regulations – Approved Document B to the Building Regulations (England and Wales) recognises the importance of independent product conformity certification. It states: 'Third party conformity certification schemes not only provide a means of identifying materials and designs of systems, products or structures which have demonstrated that they have the requisite performance in fire, but additionally provide confidence that the systems, materials, products or structures actually supplied are provided to the same specification or design as that tested/assessed.'

The estimated frequency of operation of doors is shown in table B.

Corrosion – Hinges are tested in a laboratory controlled environment for corrosion resistance as specified in BS EN 1670:1998.

Strength and Durability – Specification for hinges detailed in this catalogue meet European Standard BS/EN 1935 : 2002.

Technical Information

Hinges Drilled for Projection

The ‘P’ symbol shown next to various hinges throughout the catalogue highlights our Projection Hinges. These are drilled with holes towards the edge of a broad hinge leaf enabling the hinge to clear obstructions when fully open beyond 90°.

It is recommended that the backset should not be less than 12mm (14mm if using an intumescent strip).

When a door is to be opened beyond 90° the width of a hinge can be calculated as follows: Door thickness plus inset (Normally 3.2mm) less backset. Double this and add clearance required.

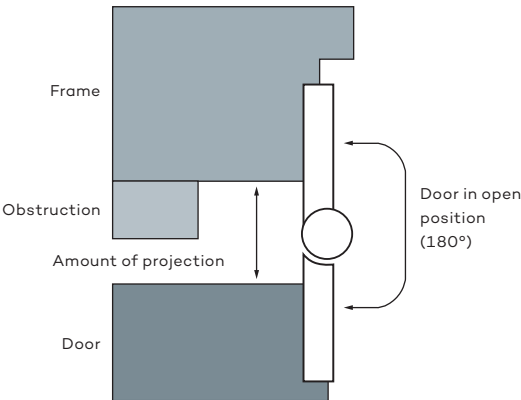
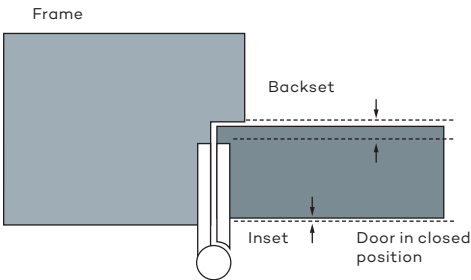
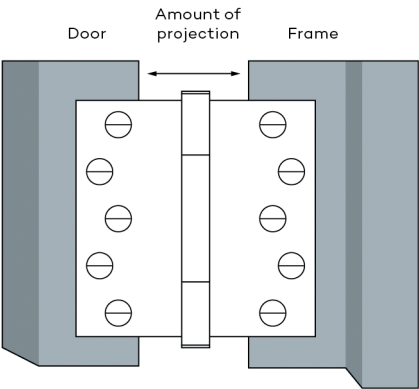

Woodscrews

Customers have the option of buying brass and aluminium hinges complete with the appropriate size and finish of woodscrews. These screws are made by a leading international manufacturer of woodscrews.

The screws are approximate matching finishes for the hinges, and although not a perfect match, are the nearest finish available.

Details are as follows:-

Gauge/Size										
N°4x1/2" (12.7mm)										
N°6x3/4" (19.05mm)										
N°8x1" (25.4mm)										
N°10x1.1/4" (32mm)										
N°12x1.1/4" (32mm)										

Gauge	2	3	4	5	6	7	8	10	12	14
d1	2.08	2.39	2.74	3.10	3.45	3.81	4.17	4.88	5.59	6.30
d2	4.07	4.67	5.35	6.05	6.73	7.43	8.13	9.51	10.90	12.30
k	1.22	1.40	1.63	1.85	2.08	2.31	2.54	2.97	3.43	3.89
n	0.75	0.87	0.92	1.02	1.15	1.15	1.27	1.40	1.53	1.78

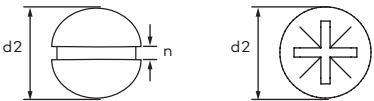
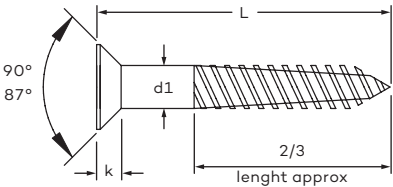

Technical Information

BS EN1935: 2002 Building hardware Single-Axis hinges – Requirements and Test Methods

The standard provides details on product types, classification by use, test cycles, door mass, corrosion resistance, as well as definitions, product performance requirements, test apparatus, test methods and making of products. In addition, the published standards include annexes illustrating the various points made through diagrams and supplementary text.

This European Standard has replaced the previous national product performance standard BS 7352: 1990 Strength and durability performance of metal hinges for side hanging applications and dimensional requirements for template drilled hinges.

SCOPE

The standard includes a wide range of hinges and includes single axis hinges and lift off hinges for use on windows and doors.

Example of eight digit code:

3	7	4	1*	1	4	0	11
---	---	---	----	---	---	---	----



DIGIT 1 – Category of use

For all internal or external doors for use by the public or others, with little or no incentive to take care. i.e. where there is chance of misuse of the door.

Grade 1 Light duty. Example: Domestic or office situation, areas with no access to general public.

Grade 2 Medium duty. Example: Domestic and office situation where limited access is allowed to the general public.

Grade 3 Heavy duty. Example: Public and institutional buildings such as libraries, hospitals and schools.

Grade 4 Severe duty. Example: Hinges for use on doors, which are subject to frequent violent usage..



DIGIT 2 – Number of test cycles

When deciding on finish and the best hinge for each application take into account; appearance to match both the environment and product; position of doors or windows within building and direction of opening; type of building use e.g. hospital and its location, coastal situation; frequency of use; (see tables AandB) security and fire resistance requirements.

TESTING – Refer to Table A

There are three categories identified for hinges manufactured to this standard.

- Grade 3 10,000 test cycles
- Grade 4 25,000 test cycles
- Grade 7 200,000 test cycles

Technical Information

DIGIT 3 – Test door mass

Eight test door mass grades are identified according to table 1 of the BS EN1935: 2002 standard.



DIGIT 4 – Fire Behaviour

Two grades of fire behaviour are identified for hinges manufactured to this standard.

Grade 0 Not Suitable for use on fire resistant and / or smoke control door assemblies

Grade 1 Suitable for use on fire / smoke resistant door assemblies subject to satisfactory assessment of the contribution of the hinges to the fire resistance of the specified fire / door assemblies.



DIGIT 5 – Safety

All hinges are required to satisfy the essential requirement of safety in use. Therefore only grade 1 is identified.



BS EN1935: 2002 Building hardware Single-Axis hinges – Requirements and Test Methods

DIGIT 6 – Corrosion resistance

Five grades of corrosion resistance are identified according to BS EN1670:

Grade 0 No defined corrosion resistance

Grade 1 Mild resistance

Grade 2 Moderate resistance

Grade 3 High resistance

Grade 4 Very high resistance



DIGIT 7 – Security - Burglar-resistance (seventh digit)

Two grades of security are identified for hinges manufactured to this European Standard:

Grade 0 Not suitable for use on burglar –resistant door assemblies;

Grade 1 Suitable for use on burglar resistant door assemblies, subject to satisfactory assessment of the contribution of the hinges to the burglar resistance of specified burglar-resistant door assemblies.



Technical Information



DIGIT 8 - Hinge grade

Fourteen grades of hinge are identified in this European Standard as detailed in Table A.



MARKING

The standard requires that single axis hinges manufactured in accordance with this standard for use on fire –resistant and or/ smoke control doors or locked doors on escape routes, shall be marked as follows:

- a) The manufacturers name or trademark or other means of identification
- b) The hinge grade according to Table A
- c) The number of the European Standard (BS EN 1935)

FIRE RATED HINGES

Hinges supplied for use on fire and escape door sets will be supplied complete with intumescent pads, which must be fitted behind each hinge flap, between the timber door and frame and the metal hinge leaves.

Table A

Grade	Max. mass of hinged door leaf kgs	Max. annual number of operations (cycles)
1	10	10,000
2	20	10,000
3	20	25,000
4	20	200,000
5	40	10,000
6	40	25,000
7	40	200,000
8	60	10,000
9	60	25,000
10	60	200,000
11	80	200,000
12	100	200,000
13	120	200,000
14	160	200,000

Technical Information

Hinge Installation

Table B

DOOR SITUATION AND ESTIMATED NUMBER OF OPERATIONS

High frequency heavy duty situations:	Daily	Annually
Large departmental store entrances	5,000	1,500,000
Large office building entrance	4,000	920,000
Cinema or theatre entrance	1,300	455,000
School entrance	1,250	225,000
Entrance door to school toilets	1,250	225,000
City centre shop entrance	1,000	300,000
Large city bank entrance	1,000	250,000
School corridor fire door	600	108,000
Town bank entrance	500	125,000
City centre restaurant entrance	500	150,000
Large office corridor fire door	450	120,000
Large office or factory toilet entrance	400	92,000
Hospital ward door	350	128,000
Medium frequency medium duty situations:		
School classroom door	80	15,000
Office door	75	18,000
Store toilet door	60	18,000
Dwelling rear or side entrance	15	5,400
Dwelling front entrance	12	4,400
Low frequency light duty situations:		
Dwelling living room communications doors	30	10,800
Dwelling bathroom/toilet door	20	7,200
Dwelling cupboard door	12	4,300
Dwelling bedroom door	9	3,200
Dwelling wardrobe/closet door	6	2,200
Dwelling cabinet furniture door	5	1,800

Table C

MASS RANGES OF TYPICAL DOORS

	Size (mm)	Mass (kg)	Duty
Cupboard, wardrobe, cabinet louvered doors and shutters	2040 x 626 x 40	3 to 10	Light
Light internal large wardrobe and large louvered doors	2040 x 926 x 40	10 to 17.5	Light
Medium internal doors	2040 x 1012 x 40	17.5 to 25	Medium
Heavy internal doors	2040 x 1012 x 40	25 to 37.5	Medium
Half hour fire doors	2040 x 826 x 44	25 to 37.5	Heavy
Light external doors	2040 x 907 x 40	20 to 37.5	Heavy
Heavy external doors	2040 x 1002 x 44	37.5 to 55	Heavy
One hour fire doors	2040 x 826 x 54	37.5 to 72.5	Heavy
Oversize or special external doors	2040 x 1200	55 to 110	Heavy

Technical Information

Hinge Calculation

One of the most important factors when determining the correct hinge is the weight of the door, this can affect the stress on the hinges by adding items of hardware, such as an overhead door closer, giving an effective door weight. To establish door weight per sq. metre use table below

Table D

Weight per square meter of door (kg)

Material	Door Thickness		
	34 mm	44 mm	54 mm
Hollow core	9.68	9.68	-
Hollow metal	31.75	31.75	31.75
Pine	14.64	17.00	20.77
Mahogany	21.96	28.00	35.52
Oak	29.28	38.75	46.28

Calculate actual door weight: DOOR HEIGHT x DOOR WIDTH x WEIGHT PER SQ METRE = ACTUAL DOOR WEIGHT

Important information, the effects on hinges with the addition of a door closer

Actual door weight + Door closer = Effective door weight

Table E

Actual door weight	Door closer (non-back check) + 20 %	= Effective door weight
	Door closer (with back check) + 75 %	
	Extra heavy use + 10 %	
	Light use – 10 %	

Doors of excessive width add a twisting and bending pressure to the hinges and also the fixings, the factor by which the door mass is calculated is by dividing the door height by the width, normally giving a factor of 2, when less than 2 the effective door weight must be increased as a percentage, please refer to side loading calculations in the table below:

Table F

Door height (mm)	Door width (mm)	Factor	Increase of mass of door leaf %
2000	1000	0	0
2000	1050	1.90	10
2000	1100	1.82	18
2000	1150	1.74	26
2000	1200	1.66	33
2000	1250	1.60	40

Note: For doors over 2100 mm in height, please consult our technical team, a forth hinge is sometimes recommended.

Location of the door and its required function can affect the life time of the hinges:

Table E

		Annual Operations
High Frequency – Heavy Duty	High risk of misuse – General public use and door closers fitted	100,000 to 1.5 million cycles
Medium Frequency – Medium Duty	Medium chance of misuse – Designated public areas	5,000 to 25,000 cycles
Low Frequency – Low Duty	High incentive to care – Private dwellings not general public	2,000 to 15,000 cycles

Technical Information

Hinge Installation

NUMBER OF HINGES

Normally three hinges are fitted to each door leaf in accordance with BS 4787 part 1. For doors exceeding 2100mm in height a fourth hinge should be used.

HINGE INSTALLATION

Hinges should be installed in accordance with the door manufacturer's recommendations and instructions. Where no such instructions are available care must be taken to ensure that the hinges are correctly aligned and fixed securely to door and frame. The screw holes should be piloted and screwheads must be flush with the hinge face to ensure that the door closes properly.

HINGE POSITIONING

It is usually acceptable to line up the centre hinge with the door handle.

Equally spaced hinges will minimise warping which may occur in environments with extremes of temperature or humidity on either side of the door, Fig.1, a and b.

Unequally spaced hinges Fig.1, c and d, improve load bearing. This is recommended where the hinges are operating near their load bearing maximum or where door closers, particularly back check door closers, are in operation and the door has a high frequency of use.

FIGURE 1

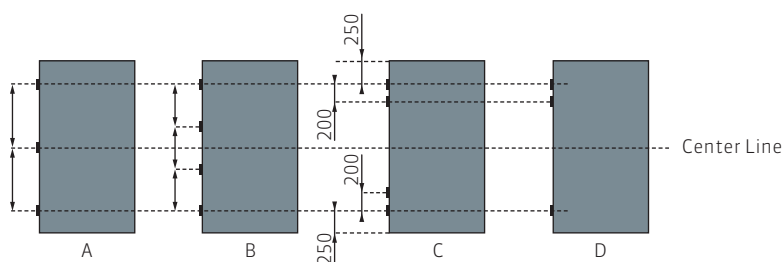

LIFT-OFF AND RISING/FALLING HINGES

Lift-off, rising and falling hinges are handed and must be specified to operate in either a clockwise closing or an anti-clockwise closing direction. The leaf with the pin in the upwards position must be fitted to the frame. Hinge operation is either clockwise closing or anti-clockwise closing and should be specified using the ISO 5 clockwise closing and ISO 6 anti-clockwise closing convention.

FIGURE 2

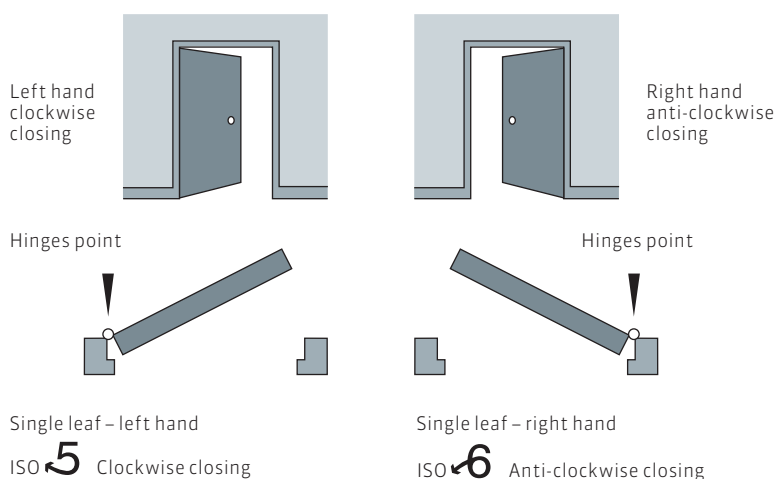

Service – comprehensive expertise for your daily work

We are happy to provide you with all the documentation you need to choose the most suitable hinge system for your requirements. Please contact us: we would be delighted to work with you to choose the best solution – from high-quality standard sets right up to the most complex solutions.

All our brochures and data sheets can be requested in a printed version, or you can simply download them on the spot – and the same applies to our fitting instructions, declarations of performance and CAD data.

Visit our **PRODUCTSELECTOR**

Whether you are a manufacturer, trade partner or designer, at www.simonswerk.com you can find precise, detailed product descriptions that will help you to choose the most suitable hinge systems.

www.simonswerk.co.uk



SIMONSWERK GROUP – excellence in product and service

As an internationally operating group of companies, the SIMONSWERK GROUP is the market leader in the area of high-quality hinge systems. With over 900 employees worldwide, we stand for the highest quality standards, constant willingness to innovate and long-lasting customer relationships.

The SIMONSWERK brand combines the entire expertise in hinge systems and unites technical know-how with design standards at the highest level. In addition to innovative product solutions, we offer our customers the best service exactly where it is needed. From personal customer consultations and competent training courses to customised delivery and logistics processes or digital service tools.

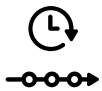

Over 130 years of experience

The perfect foundation for continuous growth with experience



Internationally successful

As the market leader, we are constantly expanding our know-how



Over 900 employees worldwide

Every single employee shapes the vision of the SIMONSWERK GROUP



Focused product solutions

With high-quality hinge systems for heavy-duty, residential and entrance doors, we offer product solutions for all applications and materials

For our customers and partners

As SIMONSWERK GROUP, we are active in a variety of business models. Both in the construction project business and in cooperation with door manufacturers as well as with hardware dealers and processors, we develop perfect solutions, depending on individual market needs. We will provide our customers and decision-makers with the best possible support as a partner in accordance with their various requirements.

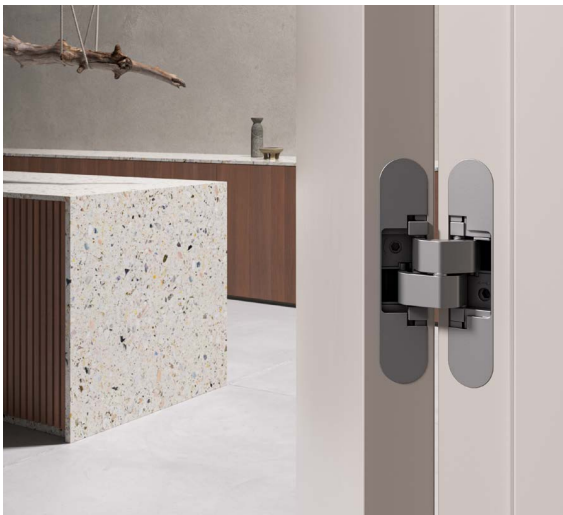
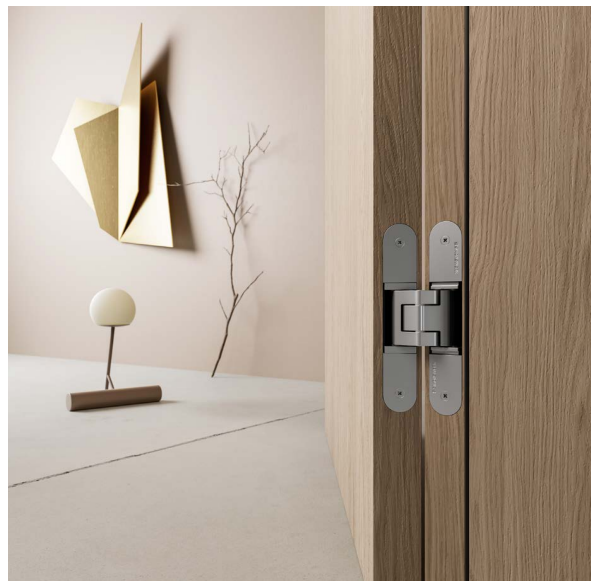

SIMONSWERK

Hinge Technology

Brass hinge systems

SIMONSWERK UK Ltd

Burcot Works, Spring Street
Tipton, West Midlands DY4 8TF
United Kingdom

☎ +44 121 5222848

✉ sales@simonswerk.co.uk

www.simonswerk.co.uk

Member of the

**SIMONSWERK
GROUP**